

Panasonic®

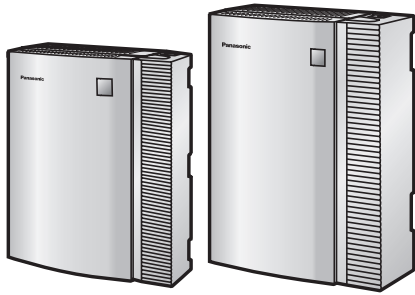

Getting Started

Voice Processing System

Model No. **KX-TVM50**
KX-TVM200



Thank you for purchasing a Panasonic Voice Processing System. This manual shows you how to install and programme this product so that you can operate the basic features.
For detailed information, refer to the Installation Manual.

KX-TVM50/KX-TVM200: Version 3.0 (Main Software Version 3.00 or later)

Table of Contents

1	Before Installation	3
1.1	Unpacking	3
1.2	Names and Locations	4
2	Installation	6
2.1	Installation Overview	6
2.2	Removing the Cable Cover	7
2.3	Opening the Front Cover	8
2.4	Removing the Dummy Cover Plates	9
2.5	Installing Optional Cards in the KX-TVM50	10
2.6	Installing Port Cards in the KX-TVM200	13
2.7	Connecting the KX-TVM50 to the KX-TDA30	16
2.8	Connecting the KX-TVM200 to the KX-TDA100	17
2.9	Connecting the VPS to a PC or LAN	18
2.10	Frame Earth Connection	19
2.11	Connecting the AC Adaptor	20
2.12	Securing the Cables	22
2.13	Initialising the VPS During Installation	24
2.14	Closing the Front Cover	25
2.15	Attaching the Cable Cover	26
2.16	Wall Mounting	27
2.16.1	Wall Mounting the VPS	27
2.16.2	Wall Mounting the AC Adaptor	28
3	KX-TDE and KX-TDA Series PBX Programming for DPT Programming	32
3.1	Assignment of VM (DPT) Group	32
3.2	Assignment of VM (DPT) Extension Ports	33
4	Programming the VPS	34
4.1	Installing KX-TVM Maintenance Console	34
4.2	Starting KX-TVM Maintenance Console	36
4.3	Quick Setup	40
4.4	LAN Settings	49
4.5	E-mail Integration Settings	50
5	System Prompts Customisation	52
5.1	System Prompts Customisation	52

1 Before Installation

1.1 Unpacking

The following items are included with the VPS.

	KX-TVM50	KX-TVM200
Main Unit	1	1
AC Adaptor	1	1
AC Cord	1	1
Screws (Wall Mounting)	5	5
Washers (Wall Mounting)	5	5
Cable strap	1	1
CD-ROM	1	1

Necessary Tools (not supplied)

Twisted pair 4-conductor cables are needed for connecting the VPS to the PBX. For the KX-TVM50, twisted pair 2-conductor cables are needed if using Inband or None Integration.

A USB cable is needed when connecting the VPS to the PC that will be used for programming via the KX-TVM Maintenance Console.

1.2 Names and Locations

KX-TVM50

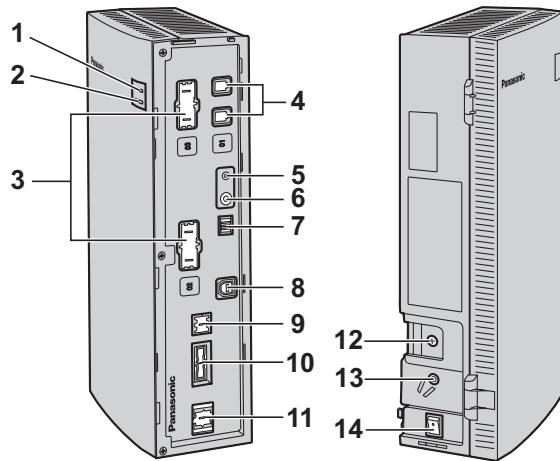

1. **RUN** Indicator
2. **ALARM** Indicator
3. Dummy Cover Plates (for Port Card Slots 2 and 3)
4. Factory-installed Jacks
5. **RESET** Button
6. **SHUTDOWN** Button
7. Mode Switch
8. USB Port
9. Dummy Cover Plate (for LAN Interface Card)
10. Dummy Cover Plate (Reserved)
11. Dummy Cover Plate (for Modem Card)
12. Earth Terminal
13. DC IN
14. Power Switch

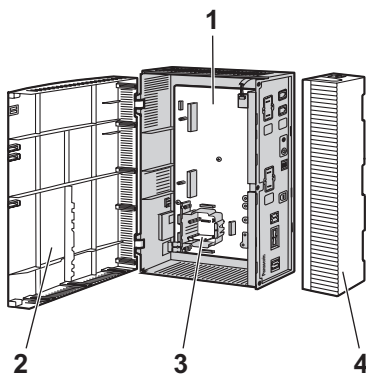

1. Main Board
2. Front Cover
3. Factory-installed Flash Memory Card
4. Cable Cover

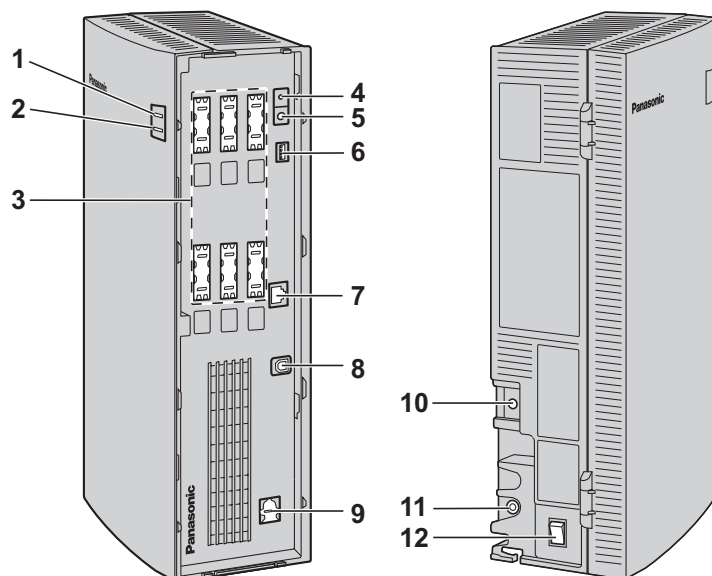
KX-TVM200

1. **RUN** Indicator
2. **ALARM** Indicator
3. Dummy Cover Plates (for Port Card Slots 1 to 6)
4. **RESET** Button
5. **SHUTDOWN** Button
6. Mode Switch
7. LAN Port
8. USB Port
9. Dummy Cover Plate (for Modem Card)
10. Earth Terminal
11. DC IN
12. Power Switch

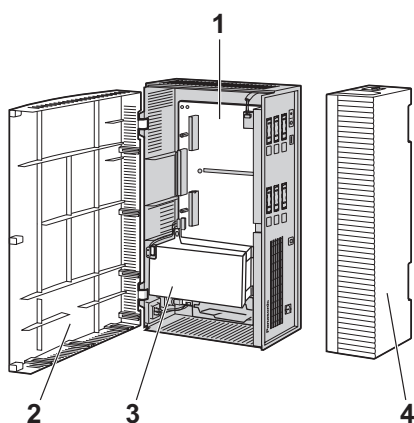

1. Main Board
2. Front Cover
3. 3.5" Hard Disk Drive
4. Cable Cover

2 Installation

2.1 Installation Overview

The following is an overview of the steps needed to prepare the VPS hardware for use. Refer to the Installation Manual when installing optional cards or hardware.

CAUTION

The information below is only intended as an overview of the installation process. When installing the VPS, refer to the information provided in this document or to the Installation Manual for detailed instructions.

1. Remove the cable cover.
2. KX-TVM200 only: Install the port cards.
3. Connect the VPS to the appropriate extension ports of the PBX.
4. Connect the VPS to the PC to be used for programming.
5. Connect the VPS to earth.
6. Connect the AC adaptor to the VPS and to the power outlet.
7. Secure the cables.
8. Initialise the VPS.
9. Attach the cable cover.
10. Wall mount the VPS and AC adaptor.

2.2 Removing the Cable Cover

The model shown here is the KX-TVM200, however this procedure is the same for the KX-TVM50. Push the release button in the direction shown below (1), and slide the cable cover in the direction shown below (2). Turn the cable cover away from the unit and remove it.

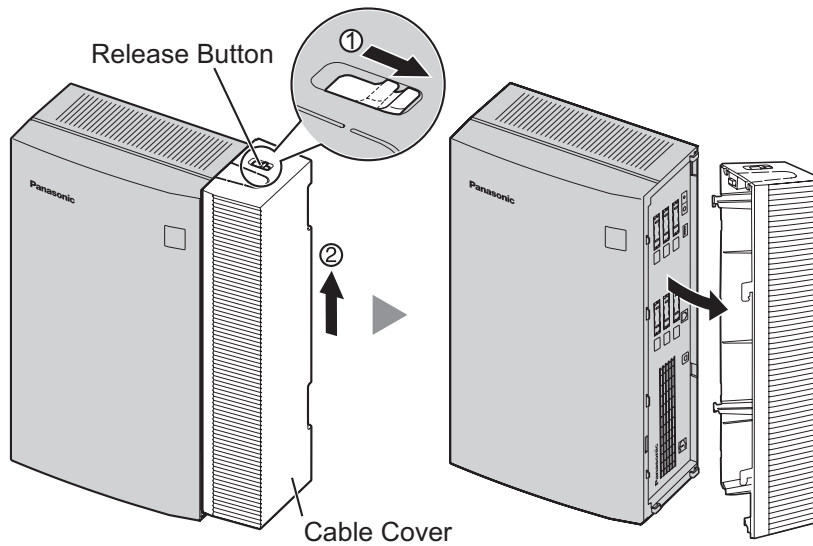

2.3 Opening the Front Cover

The model shown here is the KX-TVM200, however this procedure is the same for the KX-TVM50.

For KX-TVM50:

This procedure is not necessary if you do not plan on installing optional cards in the KX-TVM50.

1. Remove the 3 screws.

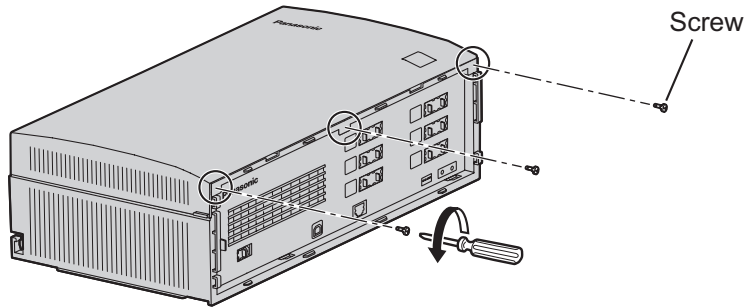

2. While holding both tabs located on the sides of the front cover, swing the cover open as shown.

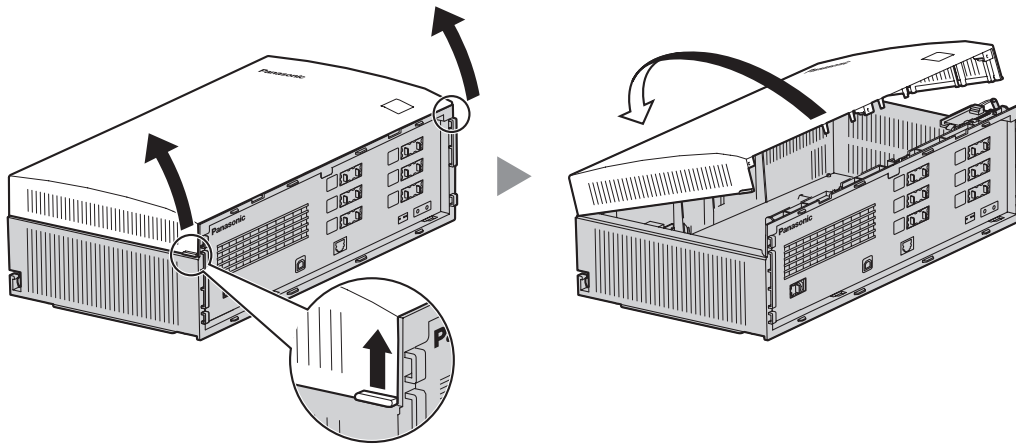

3. To remove the front cover completely during installation, hold the front cover open at a 45° angle, then lift the cover away from the unit as shown.

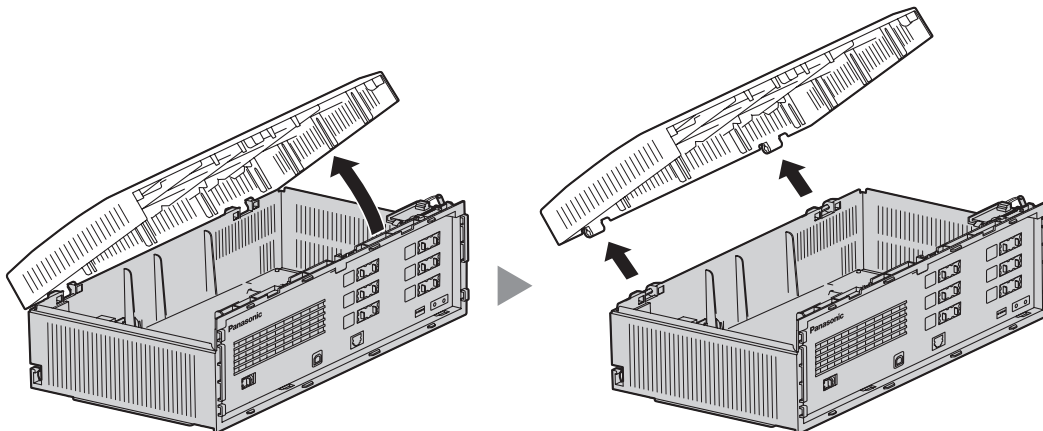

2.4 Removing the Dummy Cover Plates

The model shown here is the KX-TVM200, however this procedure is the same for the KX-TVM50.

For KX-TVM50:

This procedure is not necessary if you do not plan on installing optional cards in the KX-TVM50.

Remove the appropriate dummy cover plates from the main unit using cutting pliers, as shown below.

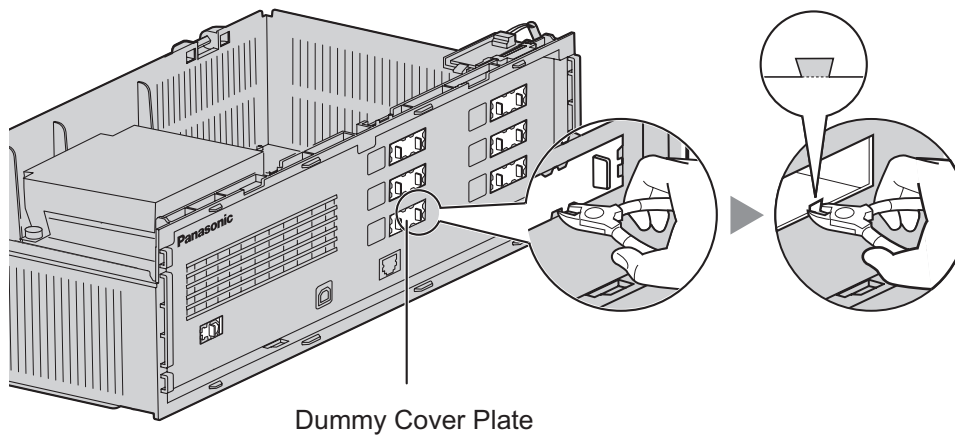

CAUTION

For safety reasons, smooth the cut edges after removing the dummy cover plates.

2.5 Installing Optional Cards in the KX-TVM50

Follow these steps if you plan to install an optional KX-TVM502 2-Port Hybrid Expansion Card or KX-TVM594 LAN Interface Card in the KX-TVM50.

Installing a 2-Port Hybrid Expansion Card

1. Position the front of the card so that the jacks fit in the open slot. Holding the card firmly in place, lower the other end of the card so that the card's hole fits over the extension bolt.

CAUTION

When installing optional cards, do not put pressure on the main board. Doing so may result in damage to the VPS.

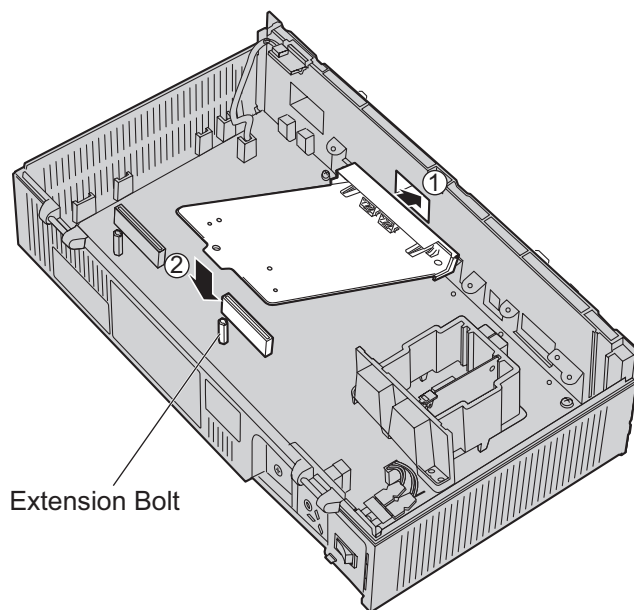

2. Insert and tighten the screws as shown.

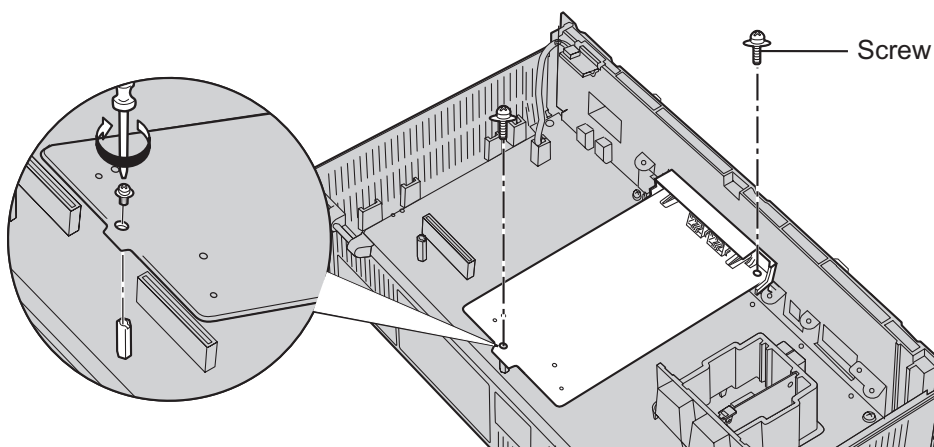

Note

The KX-TVM502 operates at SELV.

Installing the LAN Interface Card

1. Insert the card between the guide rails and slide it down as shown.
2. Secure the latch by flipping it toward the centre of the card and slightly pressing down on it.

CAUTION

When installing optional cards, do not put pressure on the main board. Doing so may result in damage to the VPS.

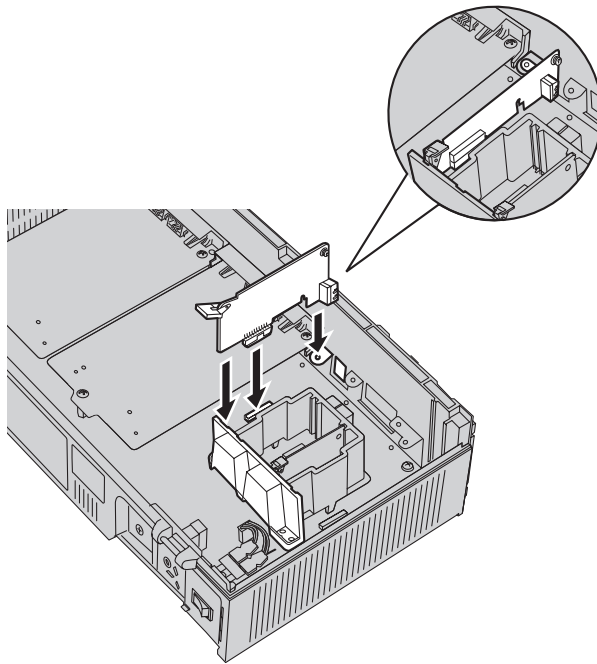

2.5 Installing Optional Cards in the KX-TVM50

3. Insert and tighten the screw as shown.

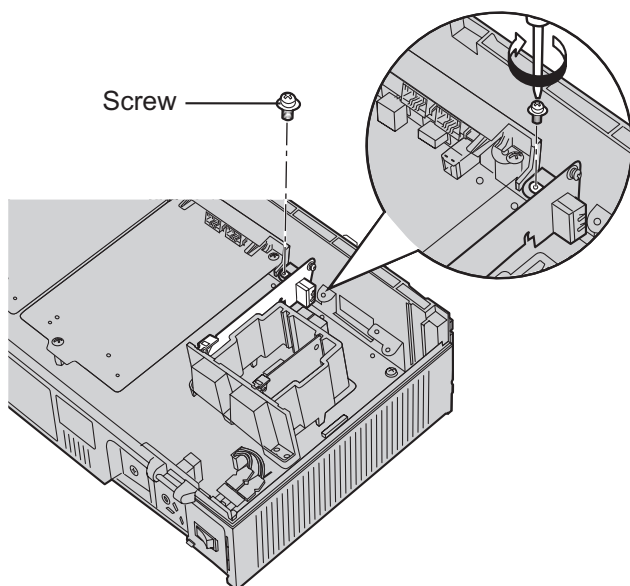

2.6 Installing Port Cards in the KX-TVM200

1. Position the front of the card so that the jacks fit in the open slot. Make sure that the tabs on both sides of the card fit into place. Holding the card firmly in place, lower the other end of the card so that the card's hole fits over the extension bolt.

CAUTION

When installing optional cards, do not put pressure on the main board. Doing so may result in damage to the VPS.

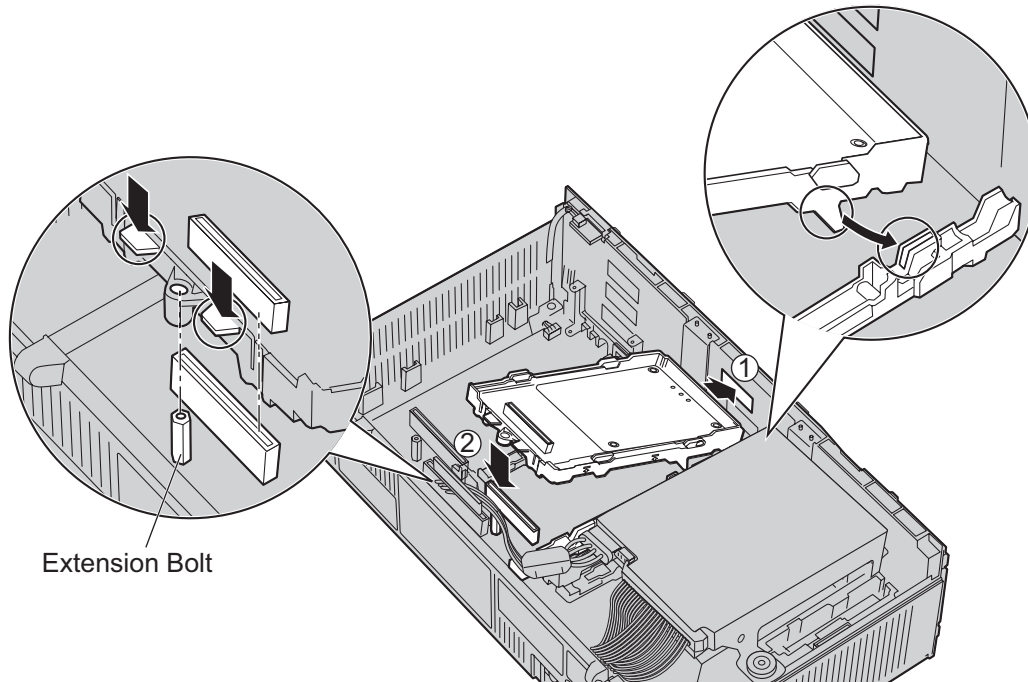

2.6 Installing Port Cards in the KX-TVM200

2. Insert the new extension bolts (included with the card) into the holes on the card, and tighten them to secure the card.

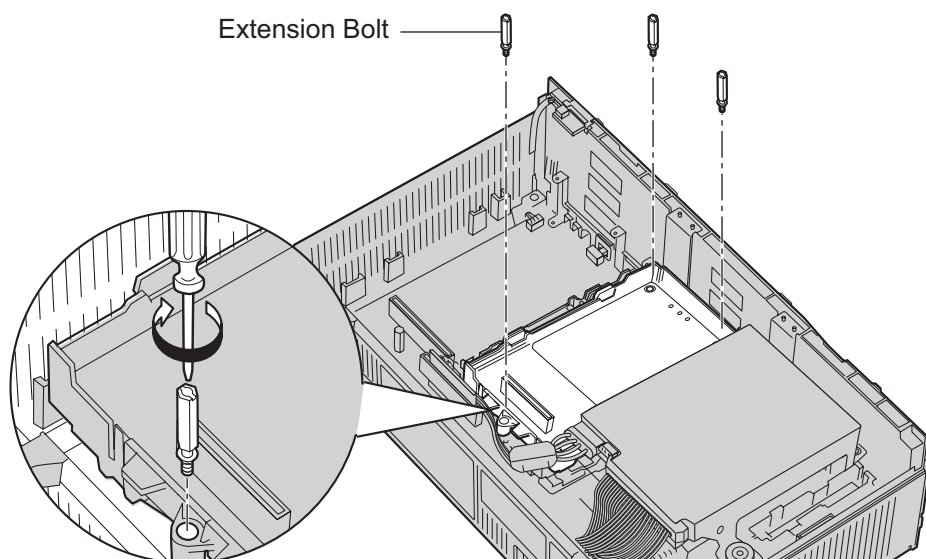

Installing Cards in Slot 5 or Slot 6

When installing a card in Slot 5 or 6, secure the card using the screws included with the card, instead of the extension bolts.

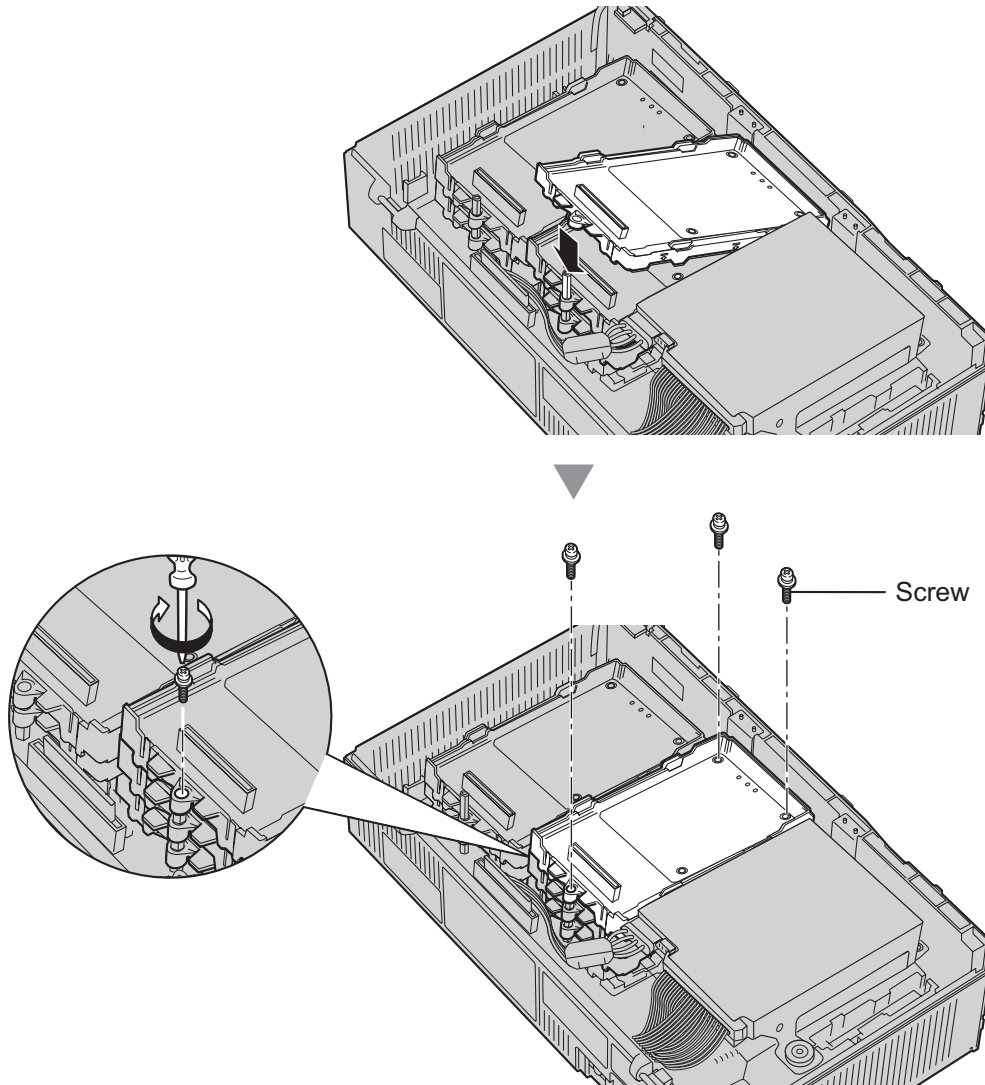

Note

- The KX-TVM204 operates at SELV.

2.7 Connecting the KX-TVM50 to the KX-TDA30

Note

- 4-conductor cables must be used in order to use DPT Integration.
- For DPT Integration, jack 1 must be connected to the lowest numbered port of the Voice Mail group assigned through PBX programming.

Connection Example (Factory-installed Jacks, DPT Integration Mode)

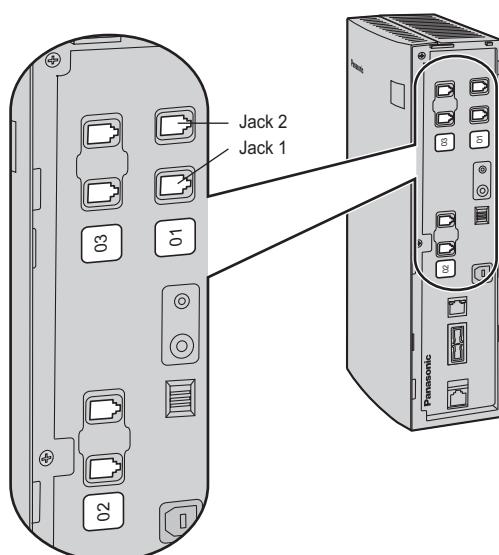
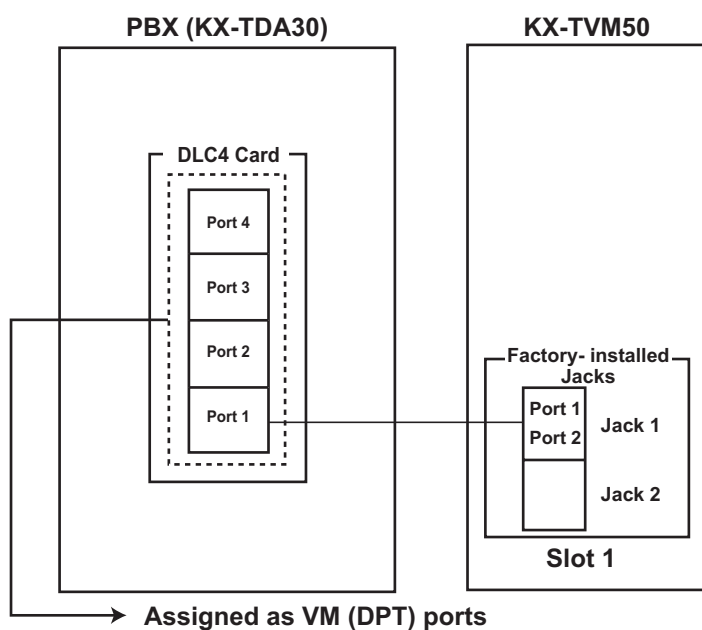

2.8 Connecting the KX-TVM200 to the KX-TDA100

Note

- 4-conductor cables must be used in order to use DPT Integration.
- For DPT Integration, the lowest numbered jack of the VPS must be connected to the lowest numbered port of the Voice Mail group assigned through PBX programming.

Connection Example (KX-TVM204 × 6, DPT Integration Mode)

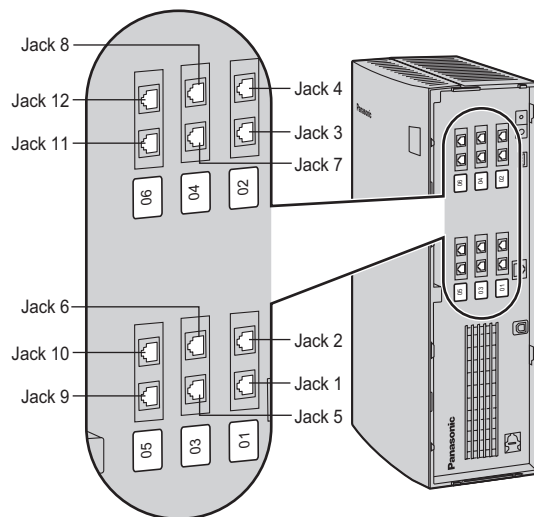
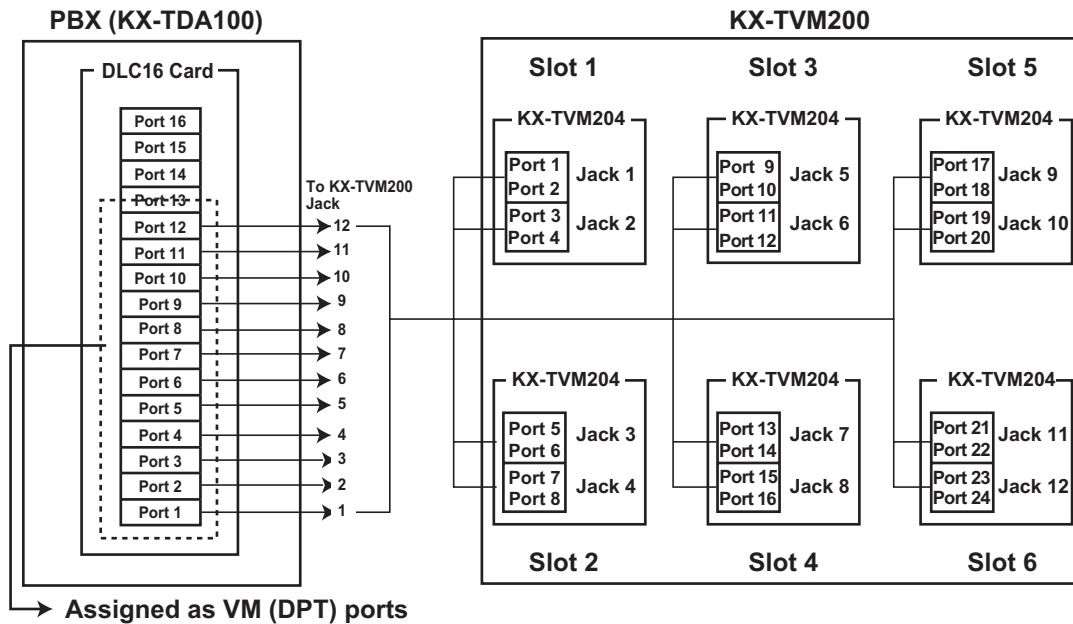

2.9 Connecting the VPS to a PC or LAN

The VPS can be connected to a PC via USB or to a LAN (optional KX-TVM594 LAN Interface Card required for KX-TVM50).

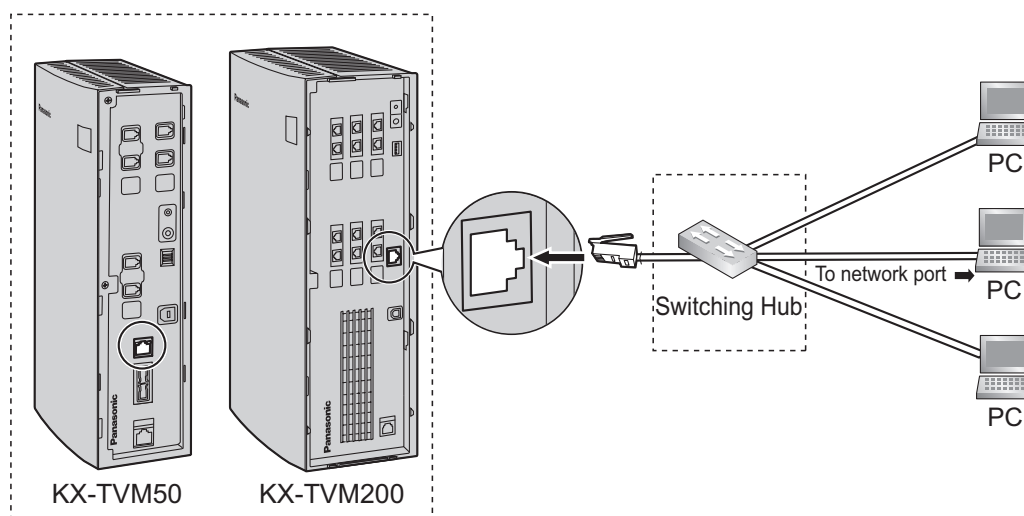
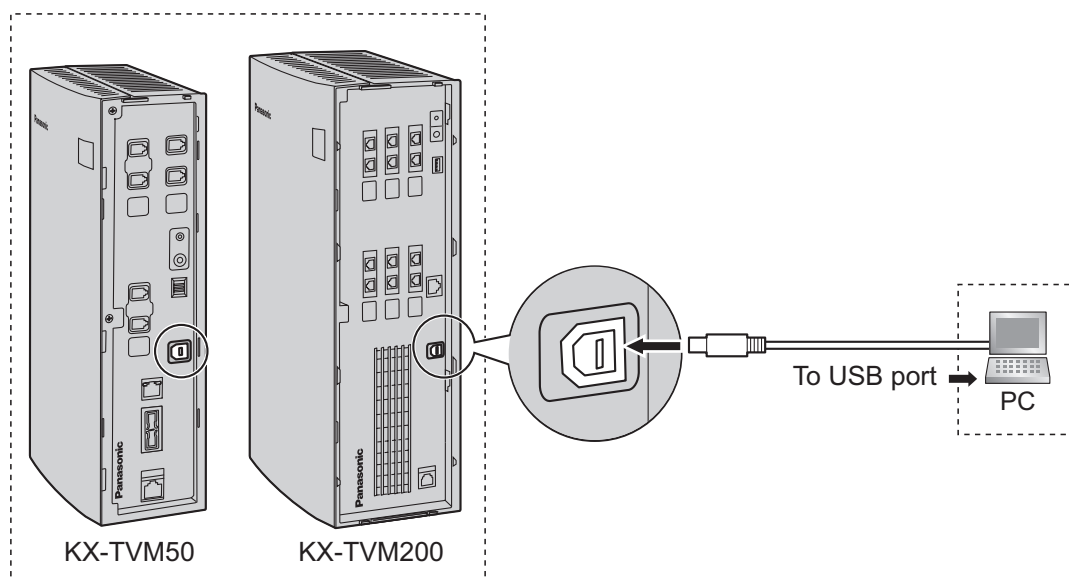

Note

- The VPS must be connected to a PC via USB for initial programming.
- We recommend using a USB cable of no more than 5 m in length.
- Use a category 5 cross cable (user-supplied) when connecting the VPS to a switching hub.
- For modem connection, refer to 2.10.3 Modem Connection in the Installation Manual.

2.10 Frame Earth Connection

IMPORTANT

Connect the frame of the main unit to earth. The earthing plug of the AC cable provides some protection from external noise and lightning strikes, but it may not be enough to fully protect the unit. A permanent connection between earth and the earth terminal of the unit must be made.

1. Loosen the screw.
2. Insert an earthing wire (user-supplied).

Note

- Green-and-yellow insulation is required, and the cross-sectional area of the conductor must be more than 0.75 mm² or 18 AWG.
3. Tighten the screw.
 4. Connect the earthing wire to earth.

KX-TVM50

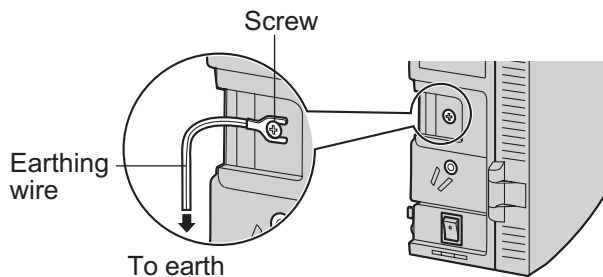

KX-TVM200

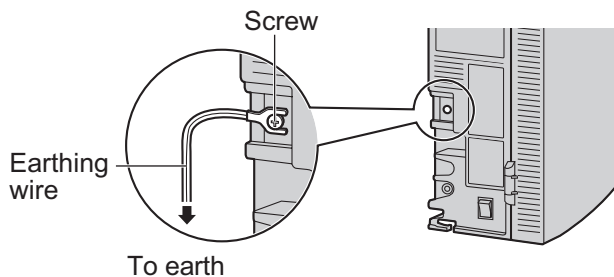

Note

- Be sure to comply with applicable local regulations (e.g., laws, guidelines).
- Proper connection to earth is very important to protect the unit from external noise, and can reduce the risk of electrocution in the event of a lightning strike.

2.11 Connecting the AC Adaptor

1. Plug the DC connector of the AC adaptor into DC IN.

KX-TVM50

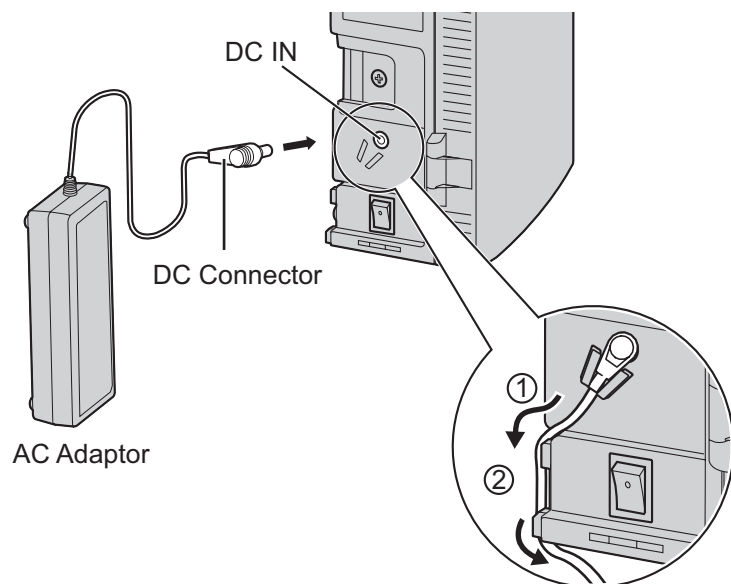

KX-TVM200

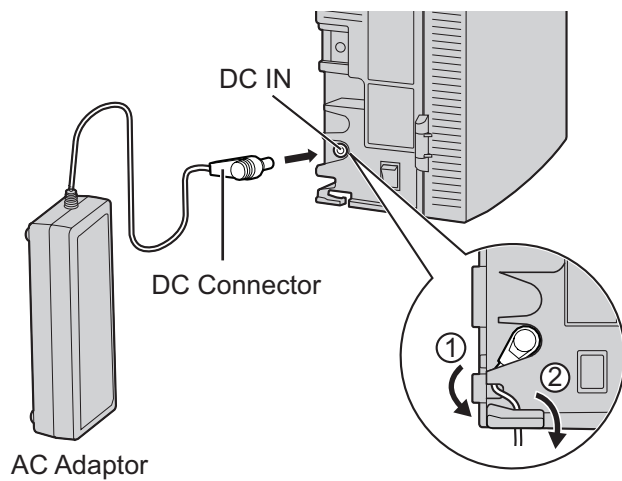

2. Confirm that the VPS power switch is in the "OFF" position, then plug the AC cord into the AC adaptor, then plug the other end into an AC outlet.

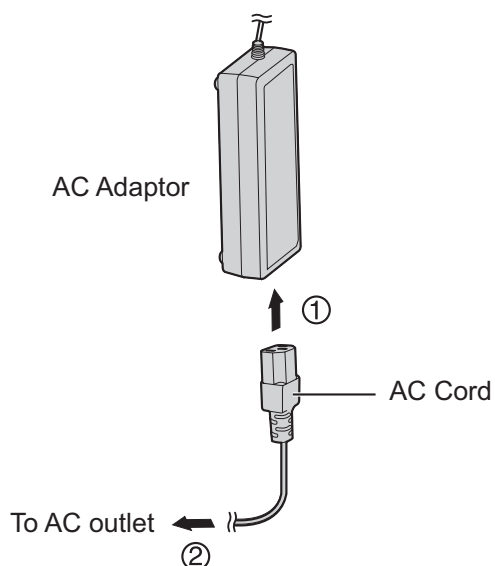
**IMPORTANT**

- KX-TVM50 AL, E, NE, NZ: Use only the included Panasonic AC adaptor, part number PNLV6504.
All other KX-TVM50 models: Use only the included Panasonic AC adaptor, part number PSLP1322.
- KX-TVM200 E, NE: Use only the included Panasonic AC adaptor, part number PNLV6505, or the KX-A236 Additional AC Adaptor.
All other KX-TVM200 models: Use only the included Panasonic AC adaptor, part number PSLP1434 or PNLV6505, or the KX-A236 Additional AC Adaptor.

2.12 Securing the Cables

The model shown here is the KX-TVM200, however this procedure is the same for the KX-TVM50.

1. Attach the included strap to either of the 2 rails depending on your preference.

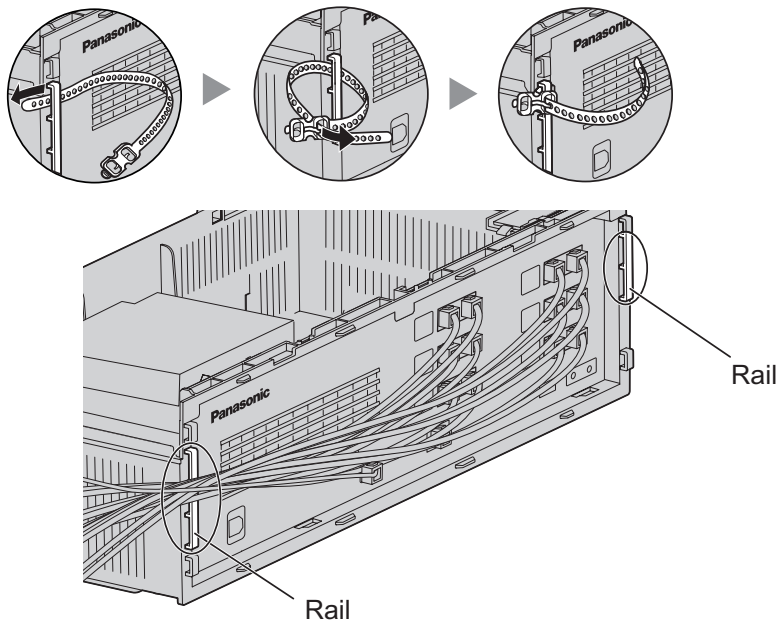

2. Bind the cables as shown.

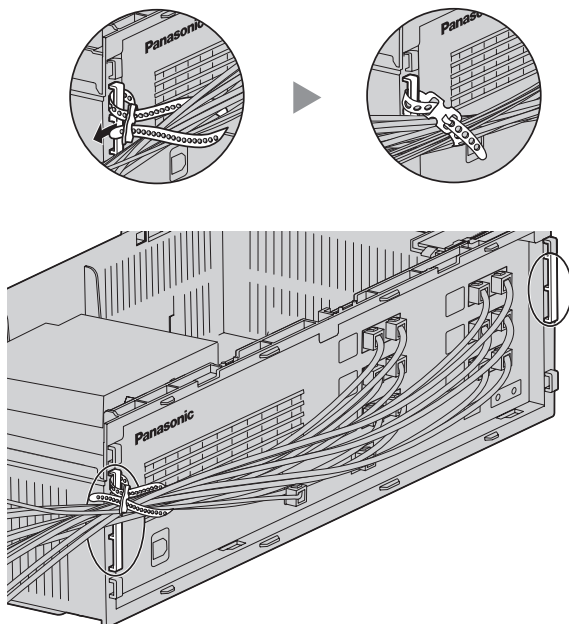

3. Attach the cable cover (2.15 Attaching the Cable Cover).

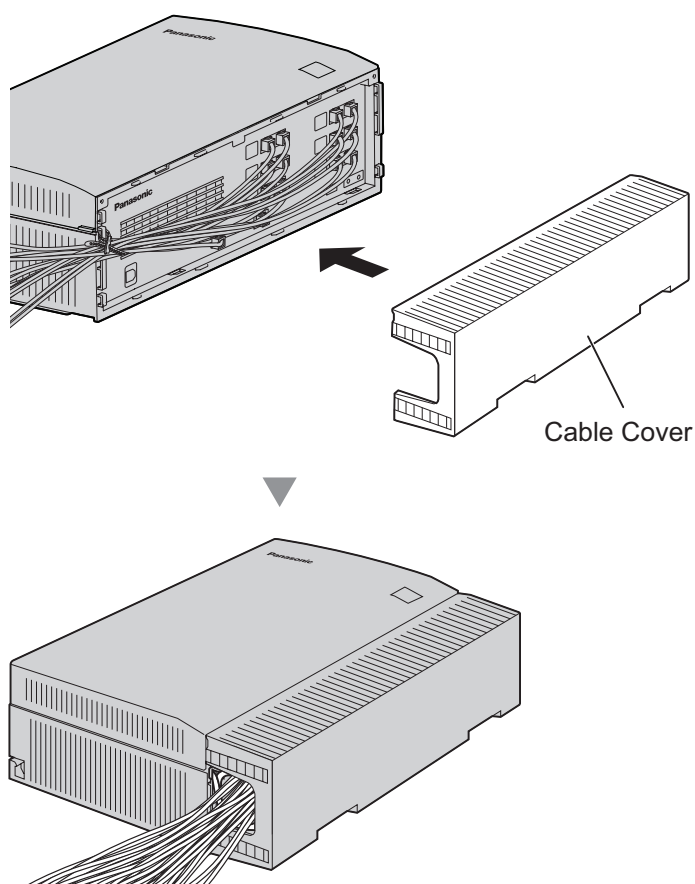

Note

- For safety reasons, do not stretch, bend, or pinch the cables.
- If you prefer, you can cut the other side of the cable cover and run the cables through that opening. For safety reasons, smooth the cut edges.

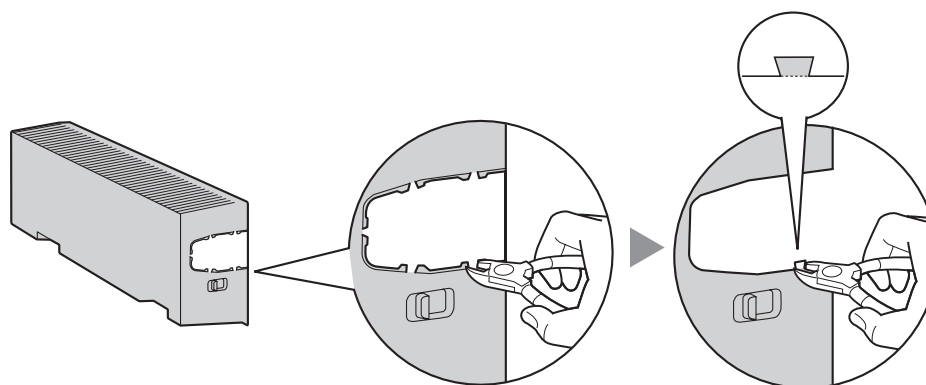

2.13 Initialising the VPS During Installation

Before programming the VPS for the first time, perform the initialisation procedure described below. All settings are reset to their default values. **Recorded messages are erased.** System Prompts (including customised prompts) are preserved.

1. Turn the power switch to the off position.
2. Set the Mode Switch to position 5 (see 1.2 Names and Locations).



- The black area in the switch illustration indicates the direction of the switch.
3. Turn the power switch to the on position.
 4. Confirm that the **RUN** indicator blinks 5 times.
 - This may take several minutes. The **ALARM** indicator and **RUN** indicator will first blink intermittently before the **RUN** indicator blinks 5 times.
 5. Turn the power switch off at the VPS.
 6. Set the Mode Switch to position 0.



- The black area in the switch illustration indicates the direction of the switch.
7. Turn the power switch back on at the VPS.

After initialising the VPS, continue with the installation procedure and/or begin programming the VPS.

2.14 Closing the Front Cover

The model shown here is the KX-TVM200, however this procedure is the same for the KX-TVM50.

1. If you removed the front cover to install optional cards, attach the front cover to the main unit as shown below.

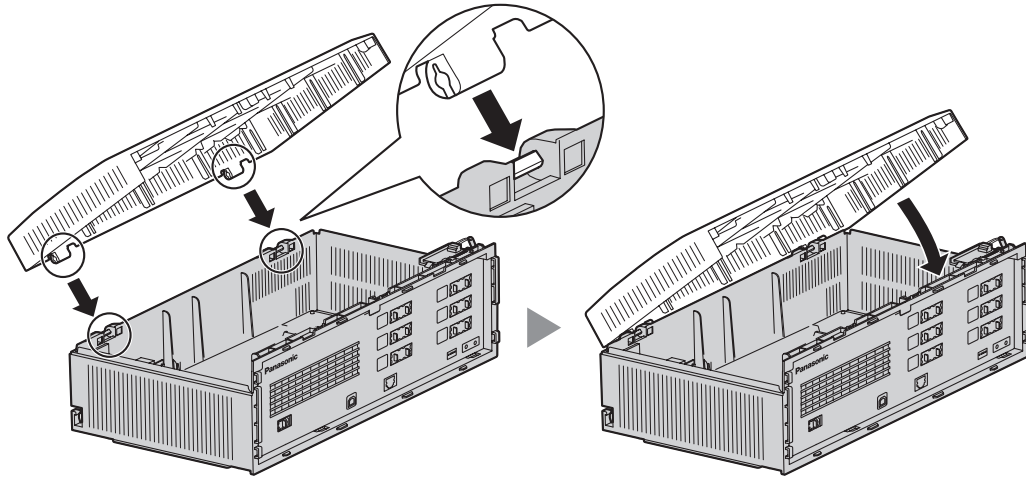

2. Close the front cover, then tighten the 3 screws.

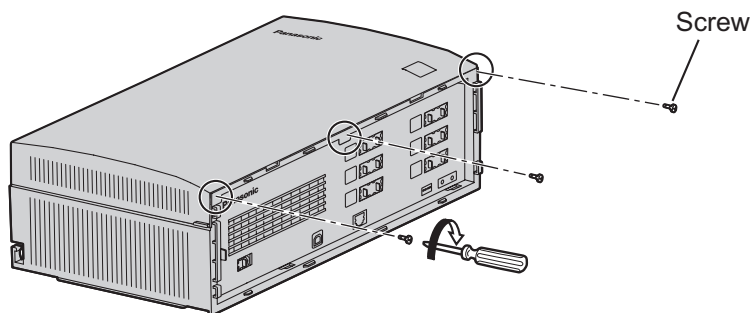

2.15 Attaching the Cable Cover

The model shown here is the KX-TVM200, however this procedure is the same for the KX-TVM50.

1. Attach the rear hooks on the cable cover to the main unit, then swing the cable cover closed so that the front hooks fit in place.

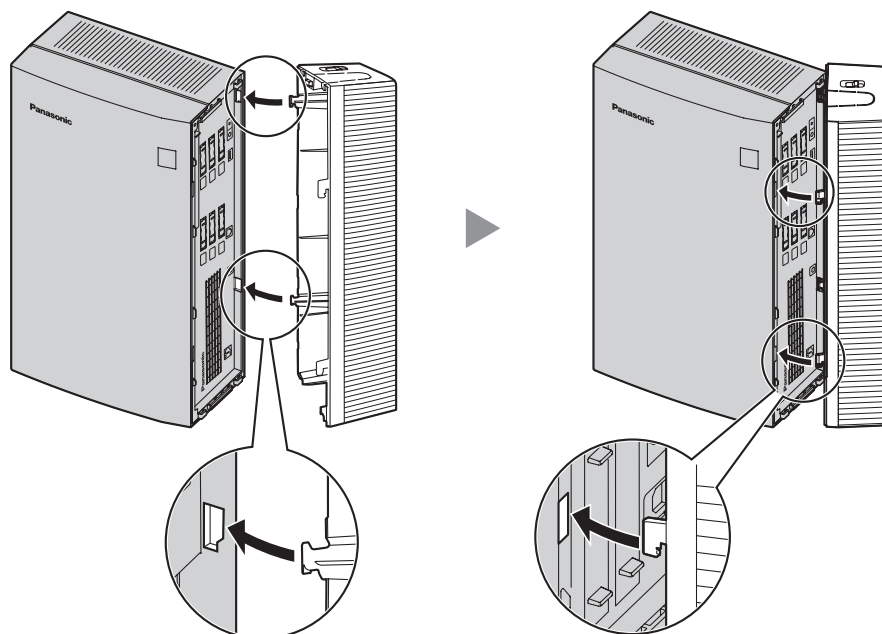

2. Slide the cable cover down until it locks.

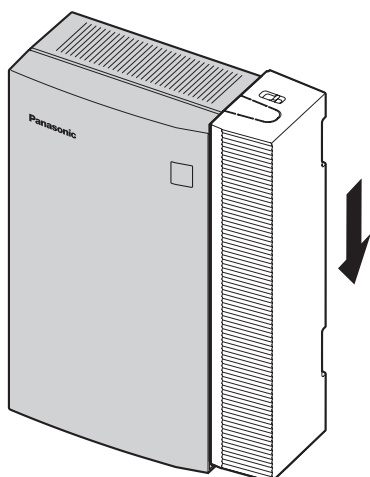

2.16 Wall Mounting

2.16.1 Wall Mounting the VPS

Mounting on a Wooden Wall

1. Place the appropriate wall mounting template (found on the last 2 pages of this manual) on the wall to mark the locations where the 3 screws need to be placed.
2. Install the screws and washers (included) in the wall.

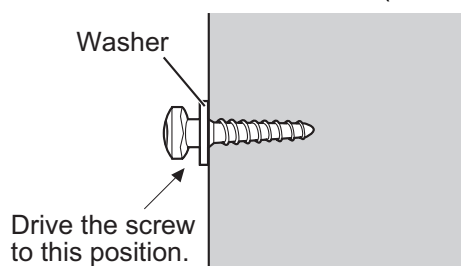

Note

- Drive the screws into the wall until each screw head is the same distance from the wall.
- Install the screws perpendicular to the wall.

3. Mount the unit as shown.

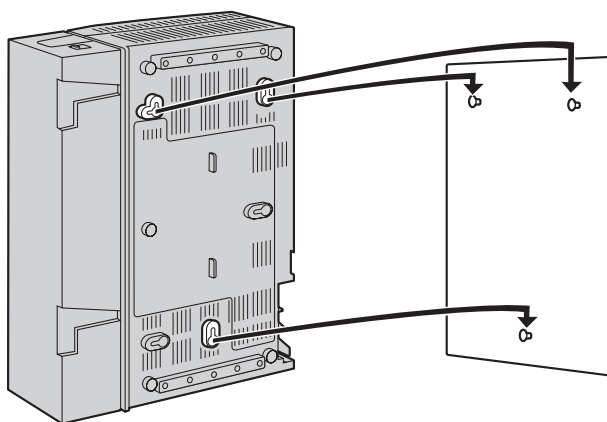

Note

- Do not block the openings of the unit. Allow space of at least 20 cm above and 10 cm on the sides of the unit.
- Make sure that the wall behind the unit is flat and free of obstructions so that the openings on the back of the unit will not be blocked.
- Be careful not to drop the unit.

Mounting on a Concrete or Mortar Wall

CAUTION

When driving the mounting screws into the wall, be careful to avoid touching any metalwork (metal/wire laths, etc.), conduits, or electrical cables buried in the wall.

2.16.2 Wall Mounting the AC Adaptor

1. Place the appropriate wall mounting template (found on the last 2 pages of this manual) on the wall to mark the locations where the 3 screws need to be placed.
2. Install 3 anchor plugs (user-supplied) in the wall, then install the screws (included) in the wall.

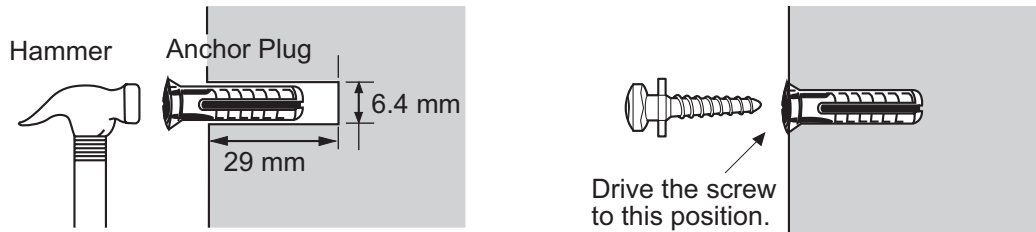

3. Mount the unit as shown.

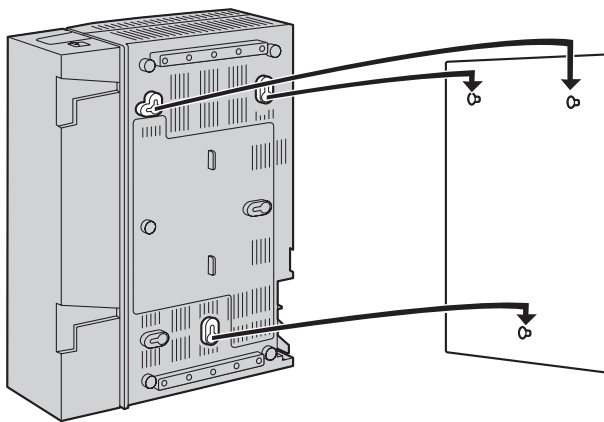

Note

- Do not block the openings of the unit. Allow space of at least 20 cm above and 10 cm on the sides of the unit.
- Make sure that the wall behind the unit is flat and free of obstructions so that the openings on the back of the unit will not be blocked.
- Be careful not to drop the unit.

2.16.2 Wall Mounting the AC Adaptor

Mounting on Wooden Wall

1. Place the AC adaptor wall mounting template (found later in this section) on the wall to mark the locations where the 2 screws need to be placed.
2. Install the screws and washers (included) in the wall.

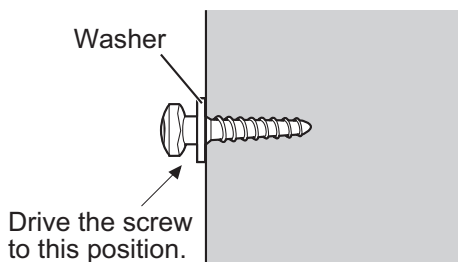

Note

- Drive the screws into the wall until each screw head is the same distance from the wall.
- Install the screws perpendicular to the wall.

3. Mount the AC adaptor as shown.

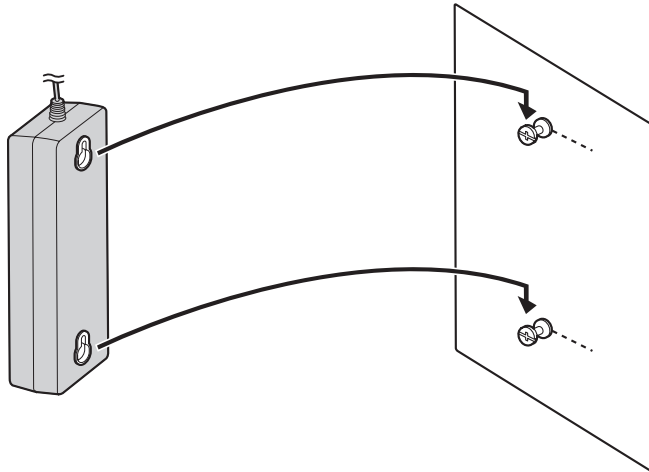

Mounting on Concrete or Mortar Wall

CAUTION

When driving the mounting screws into the wall, be careful to avoid touching any metalwork (metal/wire laths, etc.), conduits, or electrical cables buried in the wall.

1. Place the AC adaptor wall mounting template (found later in this section) on the wall to mark the locations where the 2 screws need to be placed.
2. Install 2 anchor plugs (user-supplied) in the wall, then install the screws (included) in the wall.

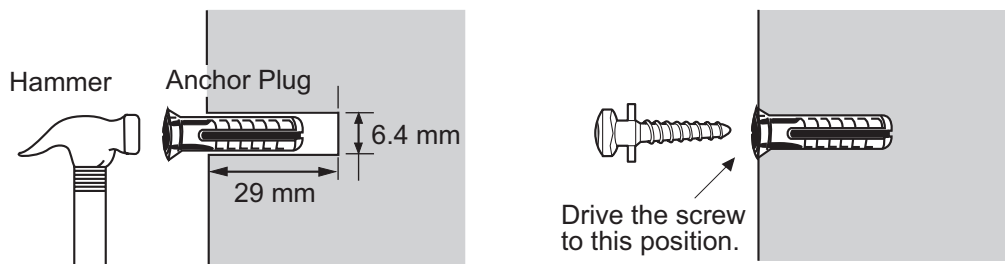

2.16.2 Wall Mounting the AC Adaptor

3. Mount the AC adaptor as shown.

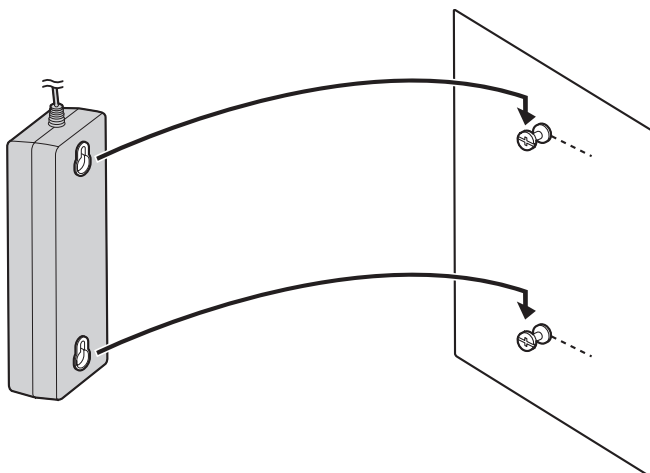

Wall Mounting Template for AC Adaptor

Please copy this page and use as a reference for wall mounting the KX-TVM50.

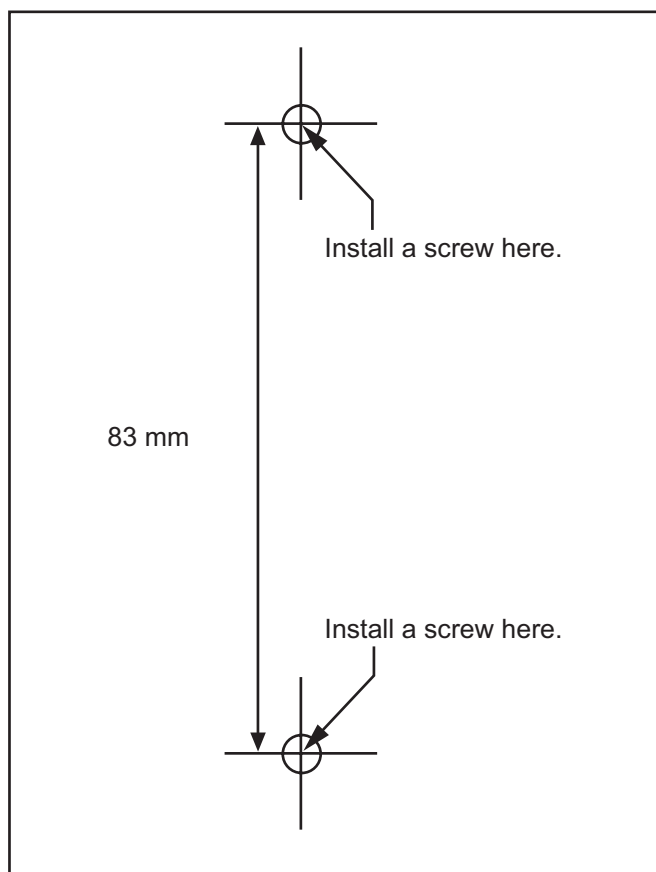

Note

- When you print out this page, the dimensions of the wall mounting template may deviate slightly from the measurements indicated in the template. Confirm that the markings on the printed page reflect the measurements indicated in the template.

Please copy this page and use as a reference for wall mounting the KX-TVM200.

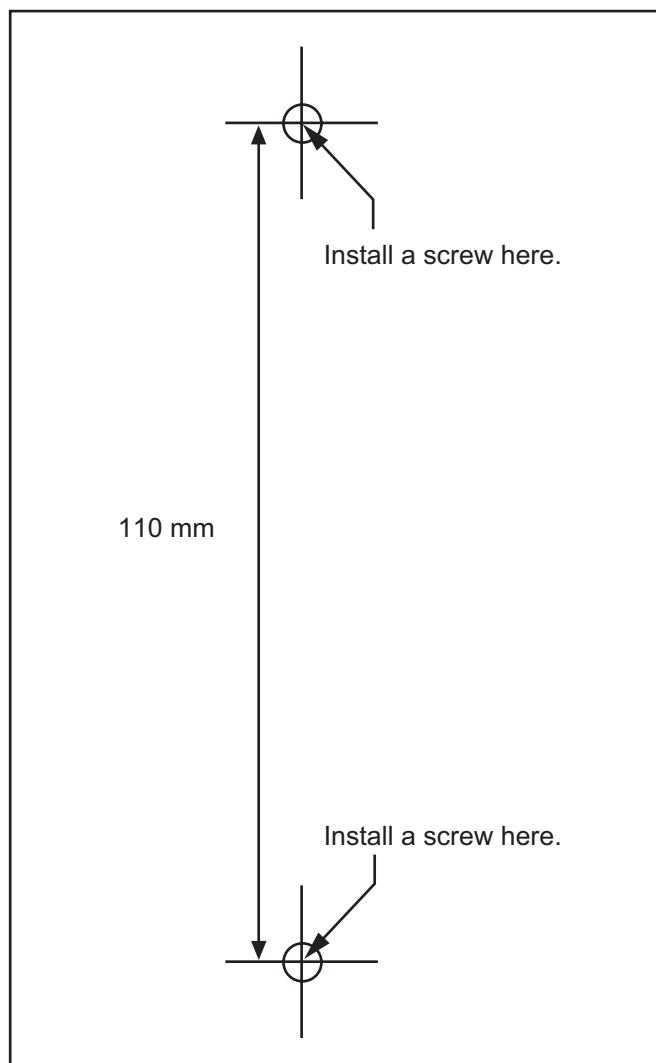

Note

- When you print out this page, the dimensions of the wall mounting template may deviate slightly from the measurements indicated in the template. Confirm that the markings on the printed page reflect the measurements indicated in the template.

3 KX-TDE and KX-TDA Series PBX Programming for DPT Programming

3.1 Assignment of VM (DPT) Group

The screen shots shown in this section are for the KX-TDA200. Programming procedures and availability may vary by country/area, software version, etc. Refer to the documentation included with the PBX or consult your dealer for more information.

The following PBX programming must be completed, using KX-TDE or KX-TDA Maintenance Console, in order to establish DPT Integration.

1. Go to the **Groups-VM(DPT) Group-Unit Setting** screen from the main screen of the KX-TDE or KX-TDA Maintenance Console installed on your PC.
2. Assign a floating extension number to the VPS.
3. Click **Apply** to save the changed data.

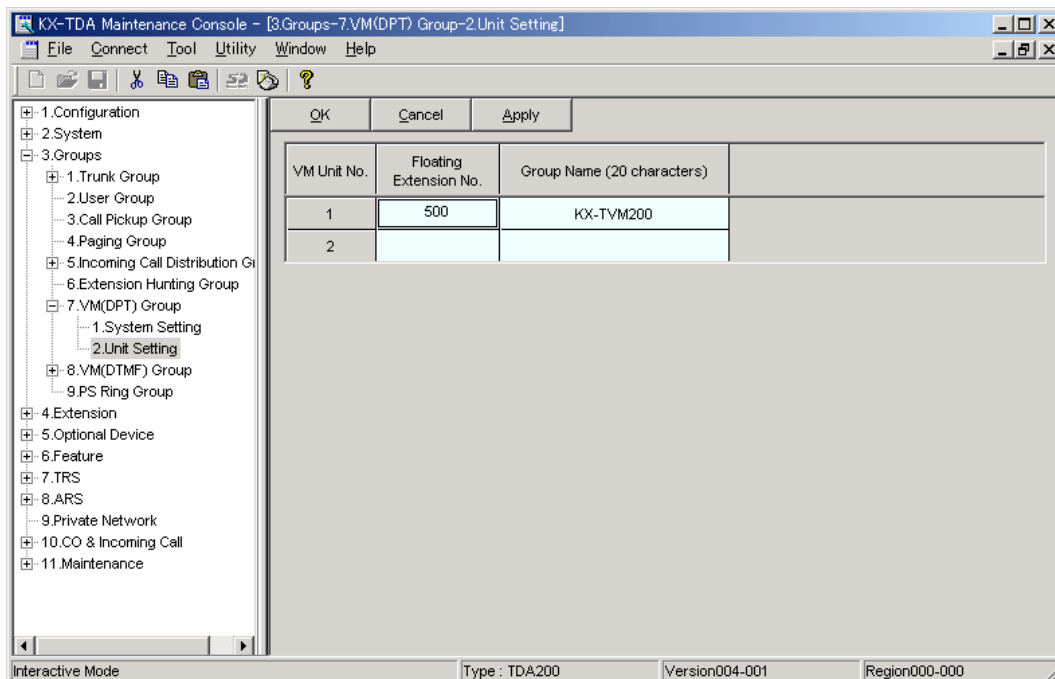

3.2 Assignment of VM (DPT) Extension Ports

1. Go to the **Configuration-Extension Port** screen. Follow the procedure below for the extension port which you want to assign as a VM port.
2. Set the port's **Connection** to **OUS**.
3. Select the attribute of **DPT Property-Type** to **VM (DPT)**.
4. Assign **DPT Property-VM Unit No.** and **DPT Property-VM Port No.**. Incoming calls will hunt starting at the lowest VM Port number.
5. Click **Apply** to save the changed data.
6. Set the port's **Connection** to **INS**.

Slot	Port	Telephone Type	Connection	Extension Number	Extension Name	XDP Mode	Parallel Telephone Ringing	DPT Property			
								Type	Location No.	VM Unit No.	VM Port No.
02	01	DPT	INS	109		Off	Yes	Normal	1	1	1
02	02	SLT	INS	110		Off	No	Normal	1	1	1
02	03	VM	INS	111	Voice Mail	On	No	VM (DPT)	1	1	1
02	04	DPT	INS	112		On	No	Normal	1	1	1
02	05	Connecti	OUS	113		On	No	Normal	1	1	1
02	06	DPT	INS	114		Off	Yes	Normal	1	1	1
02	07	DPT	INS	115		On	No	Normal	1	1	1
02	08	DPT	INS	116		On	No	Normal	1	1	1
02	XDP01	SLT	OUS	209							
02	XDP02	SLT	OUS	210							
02	XDP03	SLT	INS	211							
02	XDP04	SLT	INS	212							
02	XDP05	SLT	INS	213							
02	XDP06	SLT	OUS	214							

To determine how and when the PBX directs outside calls to the VPS, refer to 4.2 KX-TDE and KX-TDA Series PBX Programming for DPT Integration in the Installation Manual.

4 Programming the VPS

4.1 Installing KX-TVM Maintenance Console

System Requirements

Required Operating System

Microsoft® Windows® 2000, Windows XP Professional Service Pack 2, Windows Vista® Business Edition, Windows 7 32-bit Professional Edition, or Windows 7 64-bit Professional Edition

Minimum Hardware Requirements for Windows 2000, Windows XP

CPU: 1.2 GHz Intel® Pentium® microprocessor

HDD: 500 MB of available hard disk space

RAM: 256 MB of available RAM

Minimum Hardware Requirements for Windows Vista

CPU: 1.8 GHz Intel Pentium microprocessor

HDD: 500 MB of available hard disk space

RAM: 1 GB of available RAM

Minimum Hardware Requirements for Windows 7 (32-bit)

CPU: 1.8 GHz or faster 32-bit (x86) processor

HDD: 500 MB of available hard disk space

RAM: 1 GB of available RAM

Minimum Hardware Requirements for Windows 7 (64-bit)

CPU: 1.8 GHz or faster 64-bit (x64) processor

HDD: 500 MB of available hard disk space

RAM: 2 GB of available RAM

Password Security

To maintain system security, a password is required to perform system programming. We recommend changing the default password the first time you access the VPS via KX-TVM Maintenance Console. The default password can be changed by running the Quick Setup utility (see 4.3 Quick Setup) or by selecting System Security→Administrator→Password.

Warning to the Administrator regarding the system password

1. To avoid unauthorised access to VPS settings, which could result in fraudulent dialling, do not disclose the password.
2. Please inform the customer of the importance of the password and the possible dangers if it becomes known to others.
3. Please change the password periodically.
4. To prevent unauthorised access, we strongly recommend selecting a long and random password.
5. If the system password is forgotten, you have to reset the VPS to its factory defaults and reprogram it.

Note

- A Programmer Code, if set, is required to start KX-TVM Maintenance Console. You can set or delete the Programmer Code by selecting Utility→Programmer Code. If no code is set, the KX-TVM Maintenance Console can be started and used, but a password is required to connect to the VPS and change VPS settings.

Installing KX-TVM Maintenance Console



1. Copy the KX-TVM Maintenance Console setup file to a local drive on the PC. (Its icon is shown here, on the left.)
2. Double-click the setup file to run the installer.
3. Follow the on-screen instructions provided by the installation wizard.
4. Click **Yes** when prompted to copy the USB drivers, specify a location, then click **OK**.
5. Click **OK** after the drivers have been copied to the local drive.
6. Click **Finish**.

Note

- To install or uninstall the software on a PC running Windows 2000 Professional or Windows XP Professional, you must be logged in as a user that is in either the "Administrators" or "Power Users" group.
- To install or uninstall the software on a PC running Windows Vista Business or Windows 7 Professional, you must be logged in as a user in the "Administrators" group.
- When the VPS is first connected to the PC via USB, a wizard should appear and ask you to select the appropriate USB driver. Browse for and select the KX-TVM USB driver, which is copied to the local drive during installation.

4.2 Starting KX-TVM Maintenance Console

The instructions listed below explain how to start KX-TVM Maintenance Console. These instructions are for when connecting to the VPS via USB.

Note

- The screenshots shown here are for reference only, and may differ from the screens displayed on your PC.
- KX-TVM Maintenance Console uses English as the default language. See step 4 to change the language.

1. Click the **KX-TVM Maintenance Console** shortcut icon.



2. Select the appropriate VPS model and click **OK**.



3. The Set Default Parameters window is displayed the first time you start KX-TVM Maintenance Console. Select the TVM Type, PBX Type, and Integration Mode. Change the default parameters listed in the window if necessary, then click **OK**.

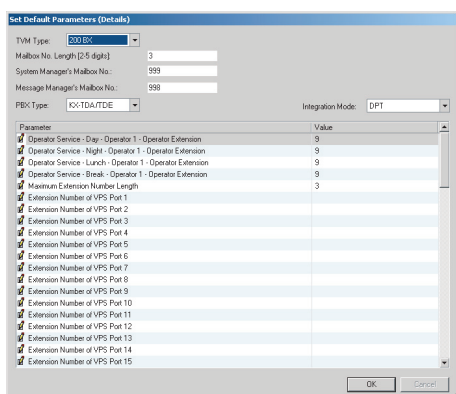

Note

- If you have already used KX-TVM Maintenance Console to change the Programmer Code, the Enter Programmer Code dialogue box is displayed. Enter the previously set Programmer Code, then click **OK**.

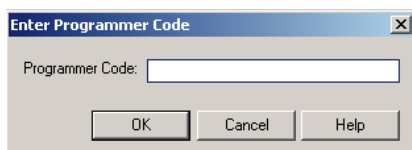

- The main window is displayed.

Note

- You can change the display language by clicking **Utility**→**Set Language...**, then selecting the desired language and clicking **OK**.
- To confirm or change the parameters in the Set Default Parameters window after changing the display language, click **Utility**→**Default Parameters**→**Set Default**.

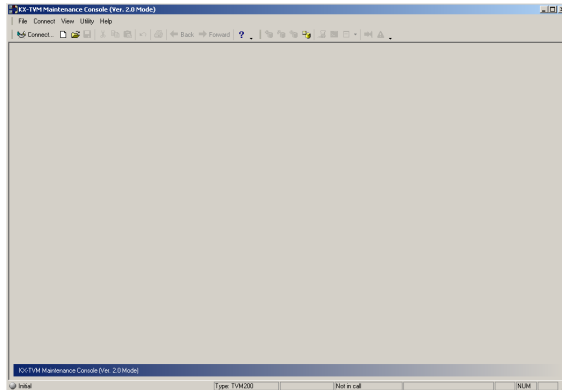

- Click **Connect** → **USB** from the menu bar, or click **Connect** on the toolbar, select **USB** in the **Connection Mode** dialogue box and click **Next**.

Note

- To connect to the VPS via USB, the KX-TVM USB driver must be installed on the PC, as explained in 4.1 Installing KX-TVM Maintenance Console.

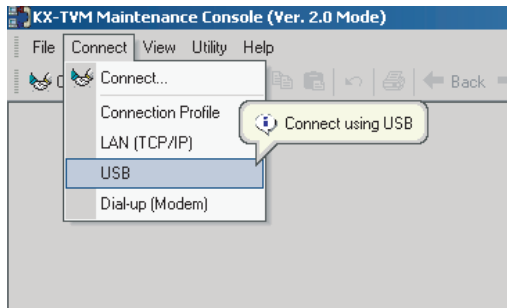

4.2 Starting KX-TVM Maintenance Console

6. Enter the administrator password (default: 1234), then click **Next**.

Note

- The administrator password is required to access the VPS for programming. The System Administrator can change the password (see "Password" in 2.8.1 Administrator in the Programming Manual).

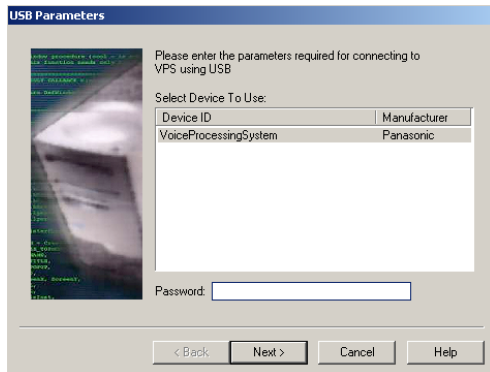

7. Click **Finish** when the message **Connected!** is displayed.
8. You may now begin programming the VPS. To choose the area you would like to begin programming, click the desired icon in the Shortcuts menu.



Note

- To connect to the VPS via LAN, first connect to the VPS via USB and set the appropriate LAN settings. Refer to 1.9.12 Utility—LAN Settings in the Programming Manual.
- To connect to the VPS via modem, refer to 1.5.4 Connect—Dial-up (Modem) (Optional) in the Programming Manual.
- If programming the VPS for the first time, the Quick Setup utility can help you program essential settings quickly and easily. See 4.3 Quick Setup for more information.
- KX-TVM Maintenance Console supports versions 1.0 and 2.0 of the KX-TVM50 and KX-TVM200. The software performs according to the version number of the connected VPS.
- Software features, design, and system requirements are subject to change.
- When connecting the KX-TVM50 with a PC running Windows 7 via USB, if the PC enters Sleep or Hybrid Sleep, the KX-TVM Maintenance Console may not be able to connect to the KX-TVM50 after it wakes from Sleep or Hybrid Sleep. If this occurs, exit the KX-TVM Maintenance Console, and then disconnect and reconnect the USB cable.

- The Reports icon in the Shortcuts menu is only available for Edition A of the KX-TVM Maintenance Console.

4.3 Quick Setup

Starting Quick Setup

1. Start KX-TVM Maintenance Console and connect to the VPS (refer to 4.2 Starting KX-TVM Maintenance Console).
2. Click **Utility** → **Quick Setup...** in the menu bar.

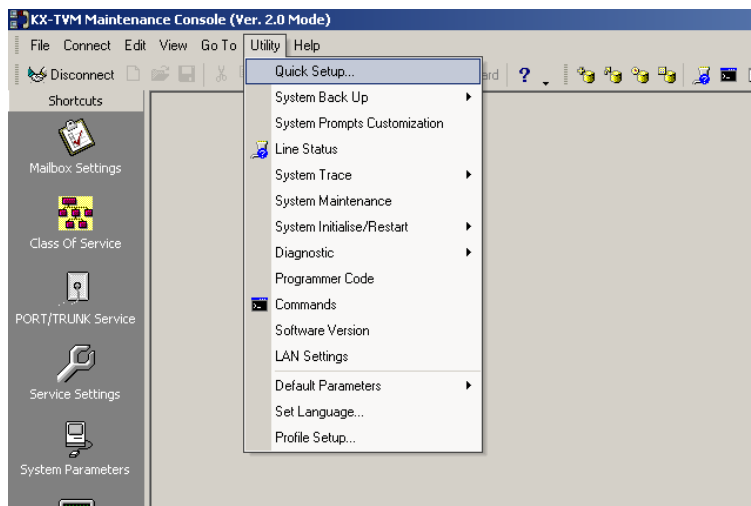

3. Click **OK** when the message is displayed.

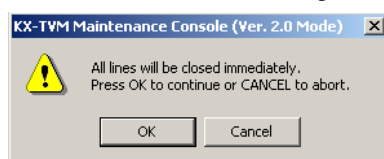

Using Quick Setup

System Security settings

After you click **Quick Setup**, the System Security window appears.

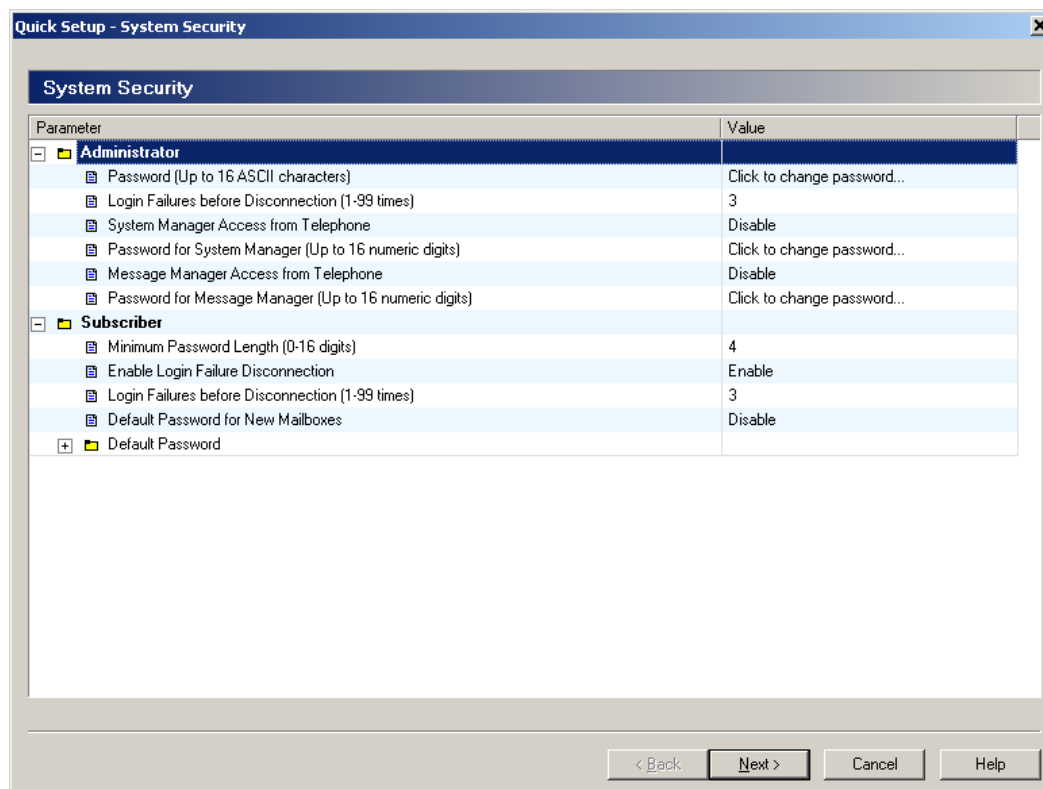

In this window, you can change the Administrator, System Manager, and Message Manager passwords, as well as other security-related settings. For more information, refer to 2.8 System Security in the Programming Manual.

Edit each parameter as needed, then click **Next**.

IMPORTANT

- To prevent unauthorised access, we strongly recommend selecting a long and random password.
- Do not carelessly reveal the password to other persons.
- Please change the password periodically.

PBX Environment settings

The next window displayed is the PBX Environment window.

Parameter	Value
PBX Environment	
PBX Type	KX-TDA/TDE
Integration Mode	DPT
Maximum Extension Number Length [2-5 digits]	3
Extension Number of VPS Port [2-3 digits]	Click to edit...
Operator Transfer Sequence (Up to 16 digits / [0-9 * # D R F T X . .])	FX
Extension Transfer Sequence (Up to 16 digits / [0-9 * # D R F T X . .])	FX
Alternate Extension Transfer Sequence (Up to 16 digits / [0-9 * # D R F T X . .])	FX
Reconnect Sequence on Busy (Up to 16 digits / [0-9 * # D R F T X . .])	F
Reconnect Sequence on No Answer (Up to 16 digits / [0-9 * # D R F T X . .])	F
Reconnect Sequence on Refuse Call (Up to 16 digits / [0-9 * # D R F T X . .])	F
Light-On Sequence for Message Waiting Lamp (Up to 16 digits / [0-9 * # D R F T X . .])	
Light-Off Sequence for Message Waiting Lamp (Up to 16 digits / [0-9 * # D R F T X . .])	
Message Waiting Lamp Retry Time (0-5 times)	2
Message Waiting Lamp Interval Time (1-60 min)	1
Call Waiting Sequence (Up to 16 digits / [0-9 * # D R F T X . .])	1
Release Sequence for Call Waiting (Up to 16 digits / [0-9 * # D R F T X . .])	F
Receiving Caller ID	Enable
Waiting Time for Receiving Caller ID (0-10 s)	0

In this window, you can select the PBX Type, Integration Mode (KX-TVM50 only), and set other parameters essential for proper integration between the PBX and VPS. For more information, refer to 2.5.4.5 PBX Parameters in the Programming Manual.

Note

- The VPS will set the appropriate parameters to match the default settings of the PBX you select as the PBX Type.

Edit each parameter as needed, then click **Next**. You will be asked whether you want to start Auto Configuration.

Click **OK** to start Auto Configuration.

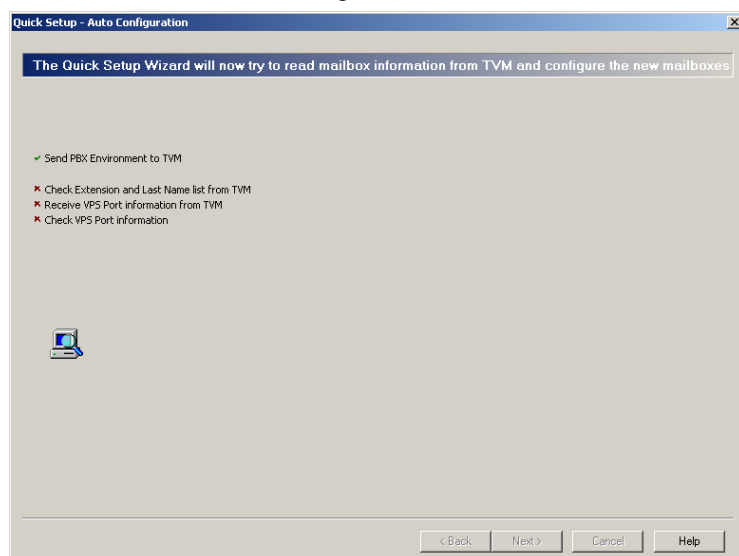

Click **Next** when the button becomes available.

Create mailboxes

The next window displayed is the Select Extensions window. Extension data retrieved from the PBX is displayed.

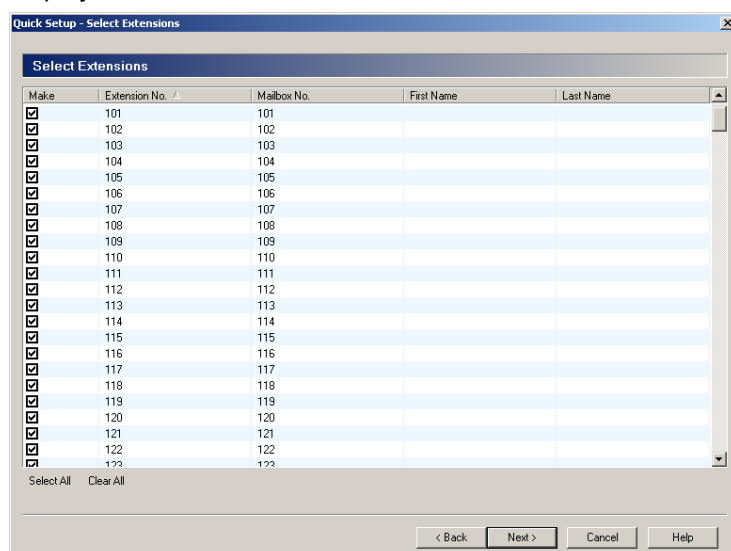

Select the extensions for which you would like to create mailboxes, then click **Next**.

Note

- Mailboxes will be created during Auto Configuration. The number of digits used for mailbox numbers is 2 to 5 digits, depending on PBX programming. The Message Manager mailbox (General Delivery Mailbox) number will be 98, 998, 9998, or 99998. The System Manager mailbox number will be 99, 999, 9999, or 99999. If both 3-digit and 4-digit extension numbers are used by the PBX, the VPS will use 4-digit mailbox numbers. When creating mailbox numbers for 3-digit extensions, a "0" will be added to the end of each mailbox number.

Example of 3-digit extension numbers converted to 4-digit mailbox numbers:

Extension Numbers	Mailbox Numbers
201	2010
202	2020
203	2030
2000	2000
2001	2001
2002	2002

- It is possible to program the VPS to allow mailbox numbers of mixed length.

Example of mixed length mailbox numbers:

Extension Numbers	Mailbox Numbers
201	201
202	202
203	203
2000	2000
2001	2001
2002	2002

In order to allow mailbox numbers of mixed length, you must enter a special command using the Commands dialogue in the KX-TVM Maintenance Console. For more information, refer to 6.2.1 Changing the Mailbox No. Length Mode in the Installation Manual.

Mailbox settings

The next window displayed is the Mailbox Edit window.

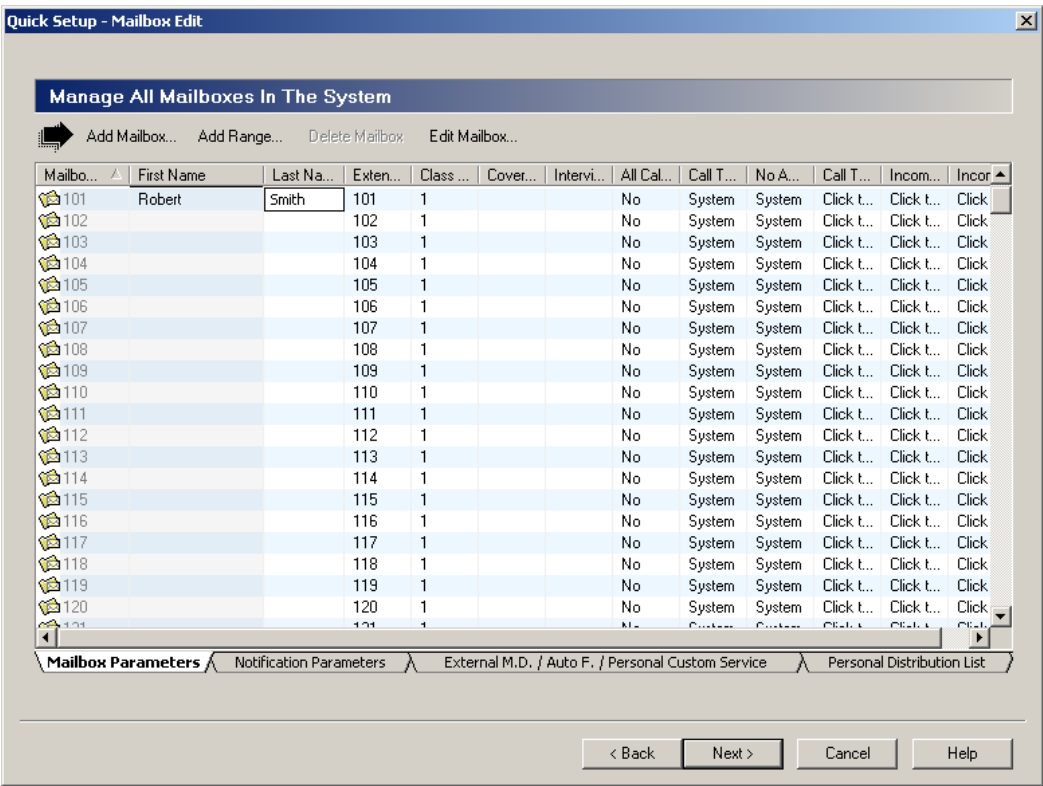

Edit, delete, or add mailboxes as needed, then click **Next**. For more information, refer to 2.1.3 Mailbox Parameters in the Programming Manual.

Note

- The Mailbox Edit window allows you to set basic mailbox parameters only. Detailed mailbox settings can be made after Quick Setup has finished, by clicking the **Mailbox Settings** icon under **Shortcuts**.

Port/Trunk settings

The next window displayed is the Port/Trunk window.

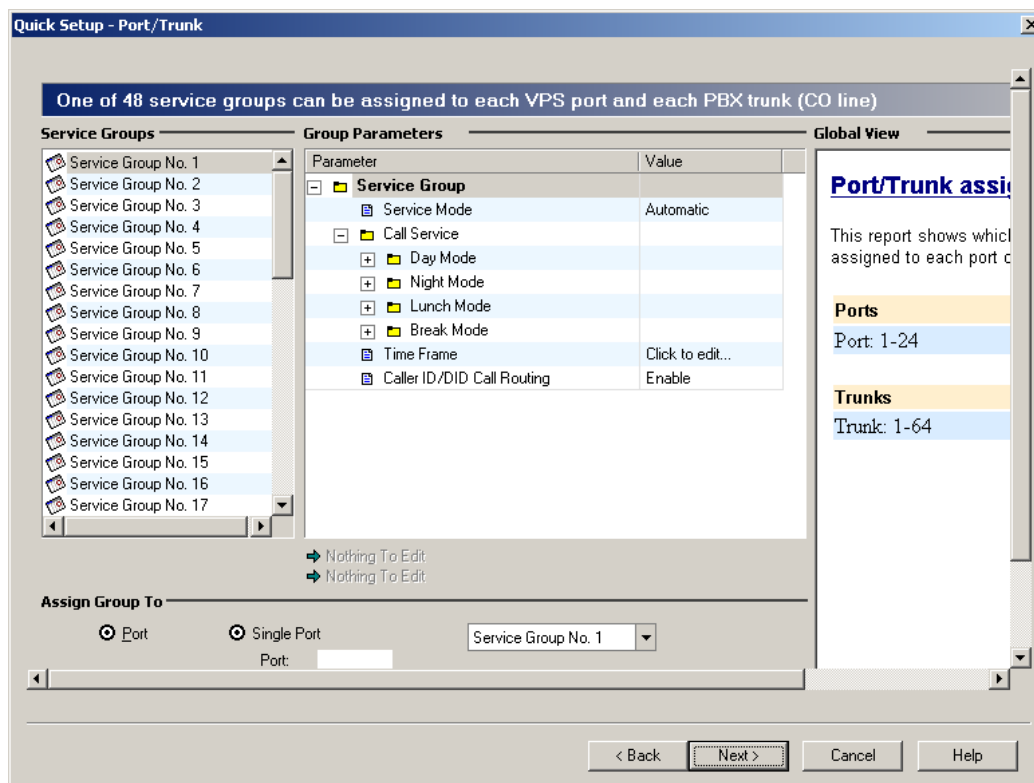

Configure Service Groups for each port/trunk, then click **Next**. For more information, refer to 2.3.1 Service Group in the Programming Manual.

Date and Time setting

The last window displayed is the date and time setting window.

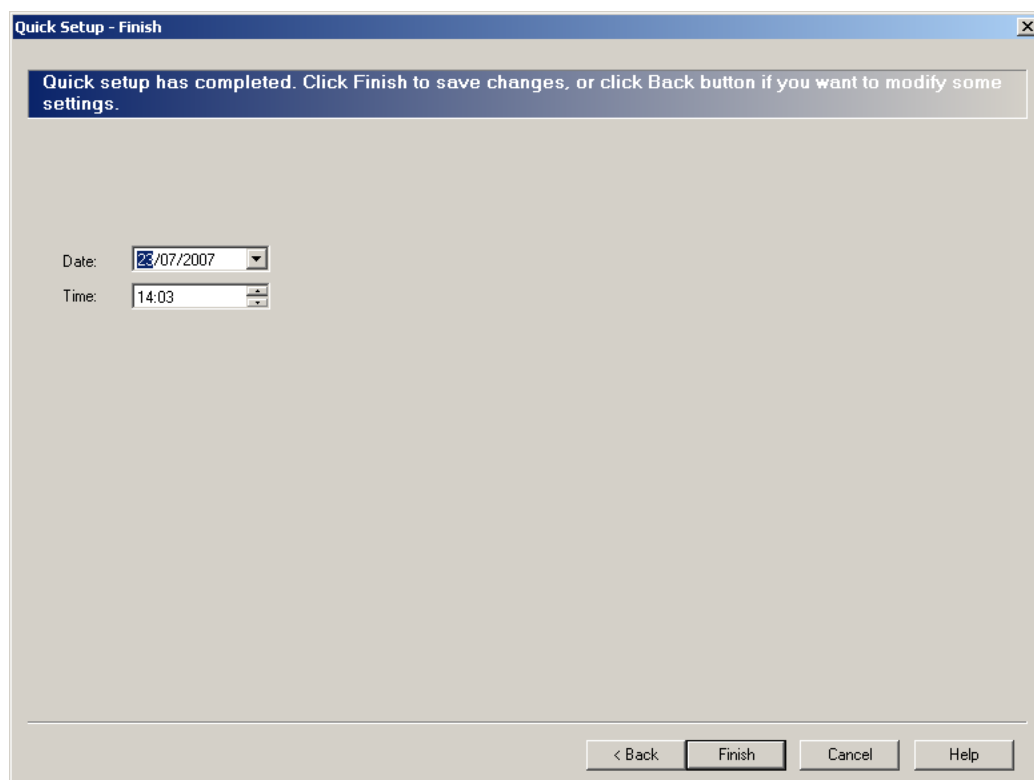

Set the date and time, then click **Finish**.

Finalising Quick Setup

Click **Yes** to save the settings and finish Quick Setup. If you click **No**, your settings will not be saved and you will return to the previous screen.

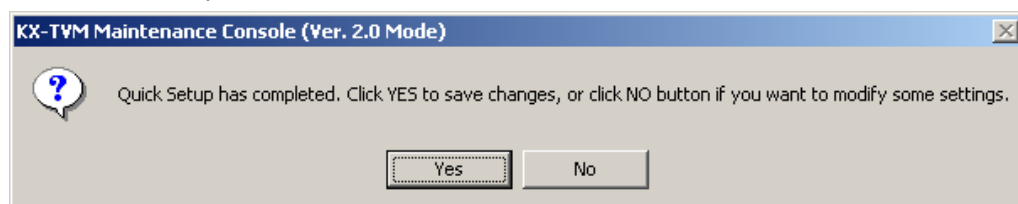

4.3 Quick Setup

If you clicked **Yes**, the following screen is displayed as your settings are saved.

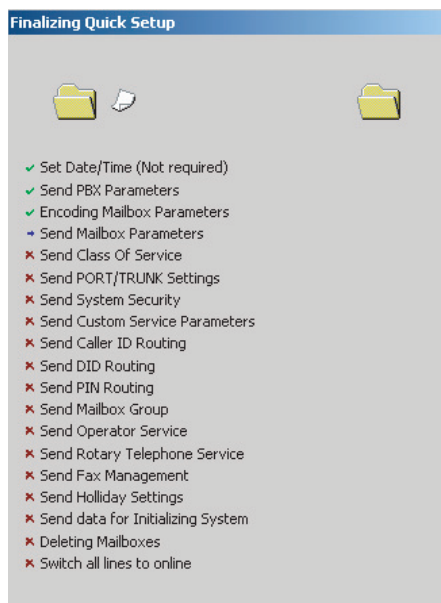

When Quick Setup is completed, the following screen will be displayed.

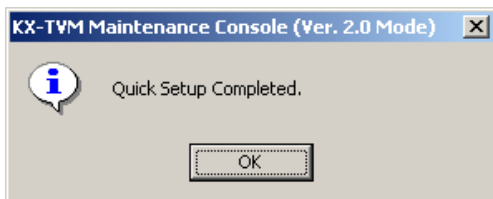

Note

- If the VPS is connected to a KX-TD500, restart the VPS to bring the VPS online.

4.4 LAN Settings

To program the VPS over a LAN connection or to use E-mail Integration features, the VPS must first be connected to the LAN and programmed accordingly.

Programming the VPS for LAN access

1. Connect the PC to the VPS via USB (refer to 2.9 Connecting the VPS to a PC or LAN).
2. Start KX-TVM Maintenance Console and connect to the VPS via USB (refer to 4.2 Starting KX-TVM Maintenance Console).
3. Click **Utility** in the menu bar.
4. Select **LAN Settings**.
5. Select "Obtain an IP address automatically", or select "Use the following IP address:" and specify the IP address, subnet mask, and default gateway.
6. Select "Obtain DNS server address automatically", or select "Use the following DNS server addresses:" and specify the preferred and alternate DNS server addresses.
7. To change the port number used for accessing the VPS over the LAN, click **Advanced Settings**, specify the port number, then click **OK**, otherwise click **OK** to close the LAN Settings dialogue box.

Note

- The port number setting is used for both LAN and modem connections to the VPS.
- Consult the LAN administrator for the appropriate settings.
- The VPS must be restarted after these settings are changed in order for them to take effect.

Accessing the VPS over the LAN

1. Start KX-TVM Maintenance Console.
2. From the **Connect** menu, select **LAN (TCP/IP)**.
3. Enter the IP address, port number, and password used to connect to the VPS.
4. Click **Next**, then click **Finish** when the connection is completed.

4.5 E-mail Integration Settings

The VPS can be programmed to send text and voice messages (as file attachments) to subscribers when they have new messages. The following settings must be made in order for the VPS to use E-mail Integration features. Consult the LAN administrator for the appropriate settings.

System Settings for E-mail Integration

1. Start KX-TVM Maintenance Console and connect to the VPS.
2. Click **System Parameters** (under **Shortcuts**), then click the **Parameters** tab.

Parameter	Value
Time Setting	
Prompt Setting	
PBX Parameters	
Dialling Parameters	
Message Waiting Notification	
External Message Delivery	
Intercom Paging Parameters	
Fax Management	
Disconnect Parameters	
Transfer to Outside	
VM Menu	
E-mail Integration	
E-mail Integration	Disable
Mail Address (Up to 128 ASCII characters)	
Full Name (Up to 64 ASCII characters)	
SMTP Server Address (Name)	
Maximum Message Length (1-30 min)	5
Advanced Settings	
SMTP Server	
SMTP Server Port (1-65535)	25
SMTP Authentication	Disable
SMTP Authentication Username (Up to 64 ASCII characters)	
SMTP Authentication Password (Up to 64 ASCII characters)	
SMTP Over SSL	Disable
POP Server	
POP Server Address (Name)	
POP Server Port (1-65535)	110
POP Before SMTP	Disable
POP Before SMTP Username (Up to 64 ASCII characters)	
POP Before SMTP Password (Up to 64 ASCII characters)	
POP Over SSL	Disable

Nothing To Edit

Mailbox Group | Extension Group | System Caller Name Announcement | **Parameters**

Note

- SMTP Over SSL and POP Over SSL are only available for Edition A of the KX-TVM Maintenance Console.

3. Set **E-mail Integration** to **Enable**.
4. Enter an e-mail address next to **Mail Address**.

Note

- We recommend entering an administrator's e-mail address here. If there are any errors when the VPS tries to send e-mail messages, error messages will be sent to this address.

5. Enter the name that will appear in e-mail messages sent from the VPS next to **Full Name**. This name should indicate that the message came from the VPS.

- Enter the IP address or host name of the outgoing mail server next to **SMTP Server Address**.

Note

- If authentication is required when accessing the outgoing mail server (SMTP server), make the appropriate settings under **Advanced Settings**.

Mailbox Settings for E-mail Integration

The following settings must be made in order for a subscriber to use E-mail Integration features.

- Start KX-TVM Maintenance Console and connect to the VPS.
- Click **Mailbox Settings** (under **Shortcuts**), then click **Add Mailbox...** or select a mailbox and click **Edit Mailbox...**

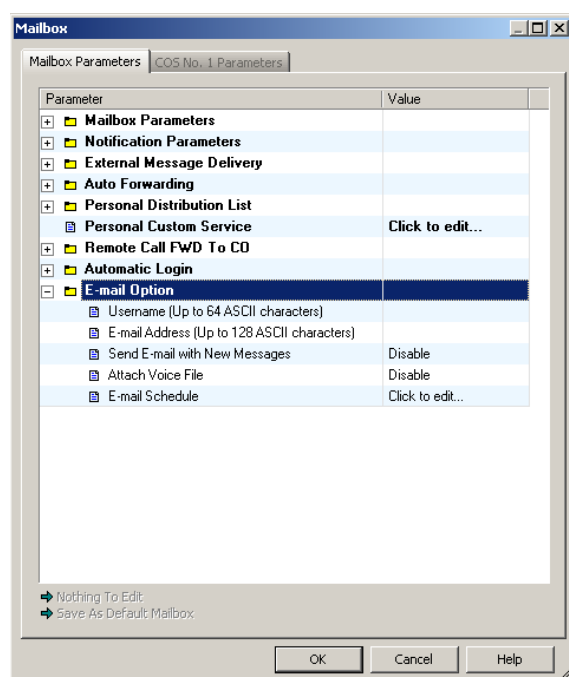

- Enter the user name for the subscriber's e-mail account next to **Username**.
- Enter the subscriber's e-mail address next to **E-mail Address**. Up to 3 addresses can be set by inserting a comma between each address.
- Set **Send E-mail with New Messages** to **Enable** to allow the subscriber to receive e-mail notifications.
- Set **Attach Voice File** to **Enable** to allow the subscriber to receive voice messages as e-mail file attachments.
- Click **Click to edit...** next to **E-mail Schedule** to determine when e-mail messages are sent, and make the appropriate settings.
- Click **OK** when finished.

5 System Prompts Customisation

5.1 System Prompts Customisation

System prompts can be customised using KX-TVM Maintenance Console and an extension telephone connected to the PBX.

Note

- The subscriber designated as the Message Manager can also customise system prompts using just his or her extension telephone. For more information, refer to the "3 Message Manager's Guide" in the Manager's Manual.

The System Prompts Customisation screen is used to view, play, add, or delete system prompts. The System Administrator can also check the prompt number and text for these prompts. The following categories of system prompts can be customised from the System Prompts Customisation screen:

- a. System Guidance
- b. Custom Service Menus
- c. Company Greetings
- d. Others
 - Company Name
 - Language Select Menu
 - Hold Announce Menu
 - Mailbox Group List Label
 - Extension Group List Label
 - System Caller ID Name

Follow the steps to customise system prompts:

1. Start KX-TVM Maintenance Console and connect to the VPS.
2. Click **Utility** in the menu bar.
3. Select **System Prompts Customisation**.
4. Select a tab in the **System Prompts Customisation** dialogue box.

[Deleting Prompts]

The System Administrator is able to delete the specific system prompt or the installed language used for system prompts.

To delete a specific system prompt:

1. Select the desired prompt number.
2. Click **Delete**.
3. Click **OK**.

To delete an installed language for system prompts:



1. Select the desired language, Guidance No.
2. Click **Delete**.
3. Click **OK**.

[Recording System Prompts]

1. Select the desired system prompt to record, and click **Play/Record**.
2. Select "Record from extension" or "Import from recorded file".

When "Record from extension" is selected

1. Specify the extension number of the telephone used for recording, then click **Connect**.
2. When the specified extension rings, go off-hook.

3. Click  (record),  (stop), or  (play) to record or play a system prompt.



4. Click **Disconnect**.

5. Click **OK**.

When "Import from recorded file" is selected

1. Click
The **Open** dialogue box appears.
2. Navigate to the folder containing the WAV files you wish to import. (WAV files must meet the following specifications: IMA ADPCM codec, 8.000 kHz, 4-bit, mono.)
3. Select the desired WAV file.
4. Click **Open** to import the file.
5. Click **OK**.

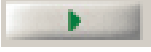
[Starting and Stopping System Prompt Playback]

1. Select the desired system prompts.
2. Click **Play/Record**.
3. Click  or .

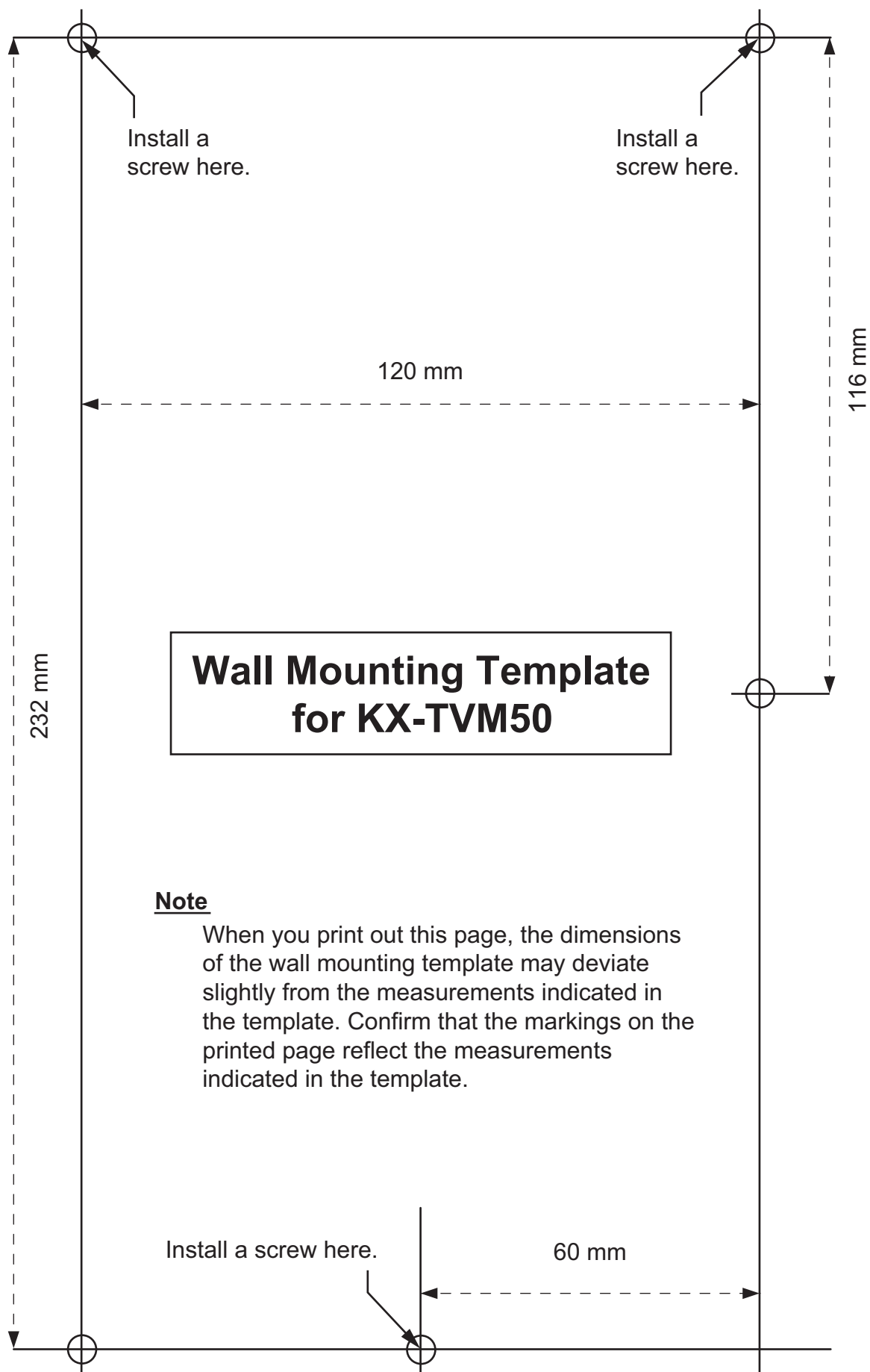

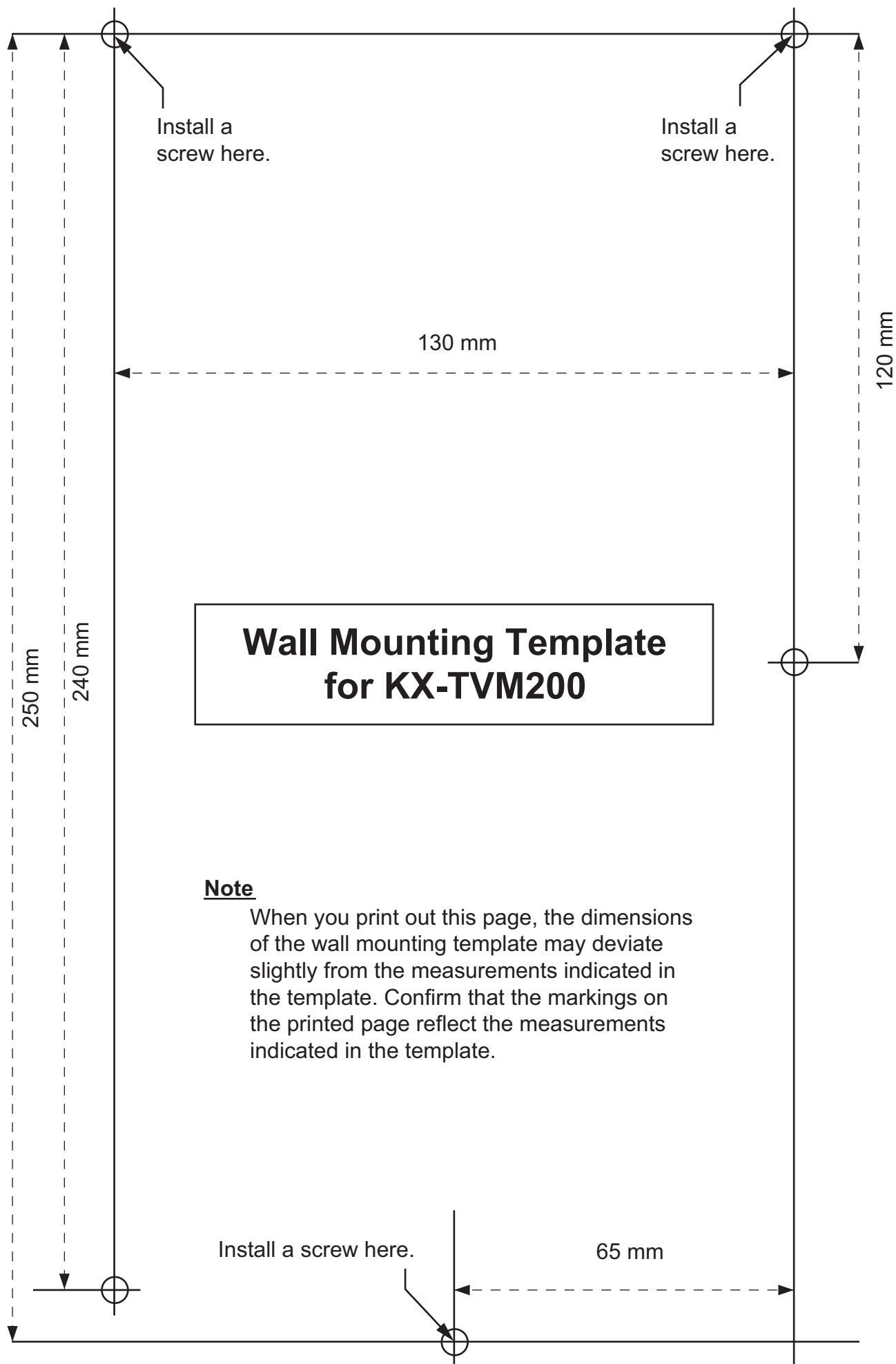

Wall Mounting Template for KX-TVM200

Note

When you print out this page, the dimensions of the wall mounting template may deviate slightly from the measurements indicated in the template. Confirm that the markings on the printed page reflect the measurements indicated in the template.

Trademarks

- Microsoft, Windows, and Windows Vista are either registered trademarks or trademarks of Microsoft Corporation in the United States and/or other countries.
- Intel and Pentium are trademarks of Intel Corporation in the United States and other countries.
- All other trademarks identified herein are the property of their respective owners.
- Microsoft product screen shot(s) reprinted with permission from Microsoft Corporation.

Panasonic System Networks Co., Ltd. declares that the KX-TVM50E/KX-TVM200E and KX-TVM50NE/KX-TVM200NE are in compliance with the essential requirements and other relevant provisions of Radio & Telecommunications Terminal Equipment (R&TTE) Directive 1999/5/EC. Declarations of Conformity for the relevant Panasonic products described in this manual are available for download by visiting:

<http://doc.panasonic.de>

Contact to Authorised Representative:

Panasonic Testing Centre
Panasonic Marketing Europe GmbH
Winsberggring 15, 22525 Hamburg, Germany



Panasonic System Networks Co., Ltd.

1-62, 4-chome, Minoshima, Hakata-ku, Fukuoka 812-8531, Japan

Copyright:

This material is copyrighted by Panasonic System Networks Co., Ltd., and may be reproduced for internal use only. All other reproduction, in whole or in part, is prohibited without the written consent of Panasonic System Networks Co., Ltd.

© Panasonic System Networks Co., Ltd. 2010

PSQX3225SA KK0205MJ7101